

EverGuard® EPDM Table of Contents System Details

Details No.	EverGuard EPDM Roof Edges	Systems
ERE-1	Standard Roof Edge	All
ERE-2	Roof Edge-Gutter	All
ERE-3	EverGuard EPDM Snap-On Roof Edge	As Noted
ERE-4	EverGuard EPDM Drain Bar	Adhered & Ballasted
ERE-5	Slotted Bar w/EverGuard EPDM Seam Tape	Adhered & Ballasted
ERE-6	Pre-Manufactured Metal Edge	Adhered & Ballasted
ERE-7	Pre-Manufactured Metal Roof Edge w/RTS Strip	Mechanically Attached
ERE-8	Roof Edge w/EverGuard EPDM Flashing Tape At Field Seam	All
ERE-9	Roof Edge w/EverGuard EPDM Flash Tape At Sheet Metal Joints & "T" Joints	All
ERE-10	EverGuard EPDM Flashing Tape Overlap At Roof Edge	All
ERE-11	EverGuard EPDM Flashing Tape At Roof Edge Corner	All

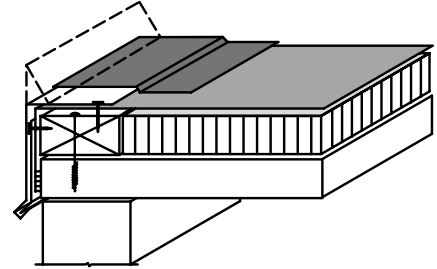
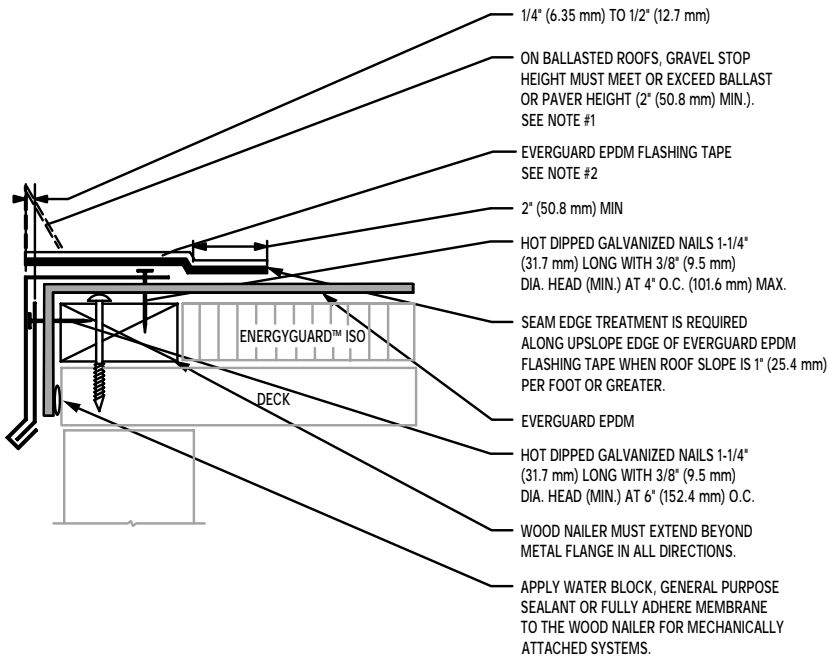

NOTES:

1. IF THE ROOF EDGE INCLUDES A GRAVEL STOP, AND SEALANT IS NOT APPLIED BETWEEN THE LAPS IN THE METAL EDGING, AN ADDITIONAL PIECE OF EVERGUARD EPDM FLASHING TAPE MUST BE APPLIED OVER THE METAL LAP AFTER THE INITIAL APPLICATION OF EVERGUARD EPDM FLASHING TAPE. LAP EDGE TREATMENT SHALL BE APPLIED AT THE INTERSECTIONS OF THE TWO FLASHING SECTIONS.
2. INSTALL THE EVERGUARD EPDM FLASHING TAPE TO A POINT 1/4" TO 1/2" FROM THE METAL EDGE. IF THE METAL EDGE FLANGE IS NOT COMPLETELY COVERED WITH EVERGUARD EPDM FLASHING TAPE THEN ALL JOINTS IN METAL SHALL BE COVERED WITH EVERGUARD EPDM FLASHING TAPE - SEE DETAIL ERE-9.

SYSTEMS: ALL
FOR USE IN GUARANTEED SYSTEMS: Up to 15 Years

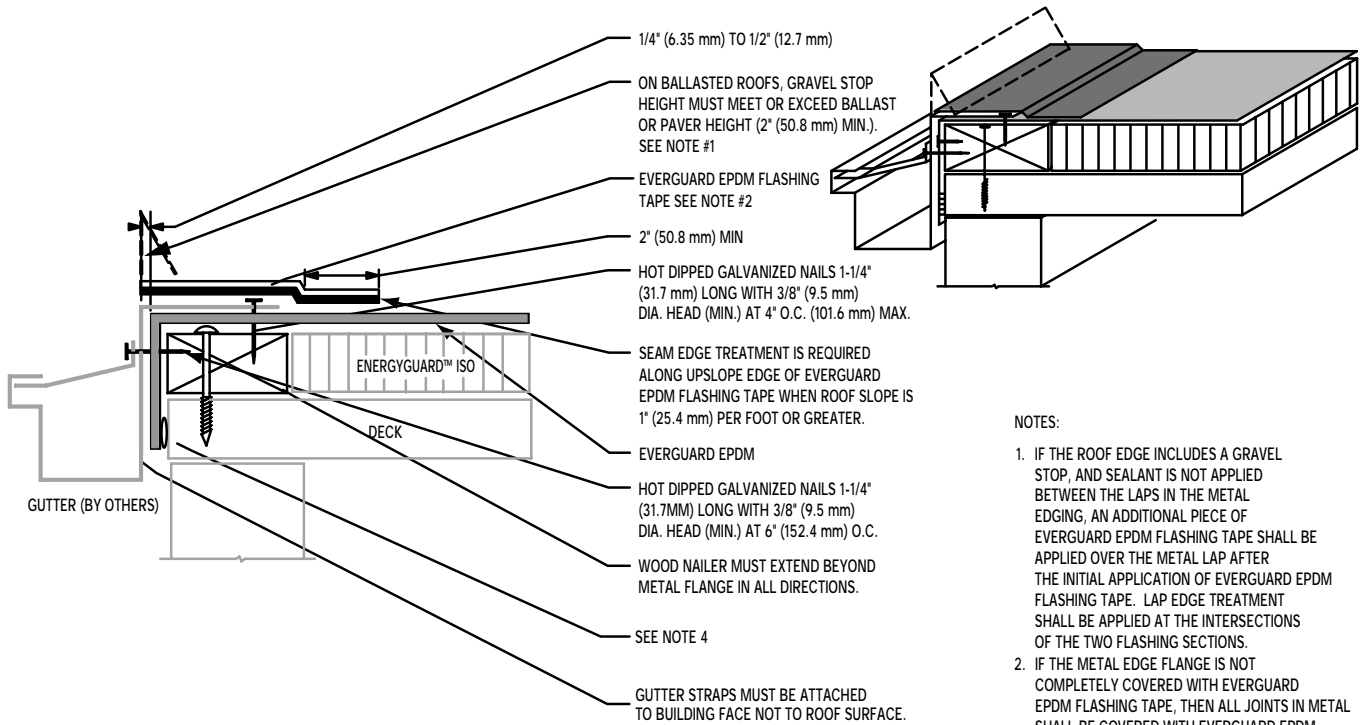

- NOTES:
1. IF THE ROOF EDGE INCLUDES A GRAVEL STOP, AND SEALANT IS NOT APPLIED BETWEEN THE LAPS IN THE METAL EDGING, AN ADDITIONAL PIECE OF EVERGUARD EPDM FLASHING TAPE SHALL BE APPLIED OVER THE METAL LAP AFTER THE INITIAL APPLICATION OF EVERGUARD EPDM FLASHING TAPE. LAP EDGE TREATMENT SHALL BE APPLIED AT THE INTERSECTIONS OF THE TWO FLASHING SECTIONS.
 2. IF THE METAL EDGE FLANGE IS NOT COMPLETELY COVERED WITH EVERGUARD EPDM FLASHING TAPE, THEN ALL JOINTS IN METAL SHALL BE COVERED WITH EVERGUARD EPDM FLASHING TAPE - SEE DETAIL ERE-11.
 3. APPLY WATER BLOCK, GENERAL PURPOSE SEALANT OR FULLY ADHERE MEMBRANE TO THE WOOD NAILER FOR MECHANICALLY ATTACHED SYSTEMS.
 4. APPLY WATER BLOCK, ALL PURPOSE SEALANT OR FULLY ADHERE MEMBRANE TO THE WOOD NAILER FOR MECHANICALLY ATTACHED SYSTEMS.

SYSTEMS: ALL
FOR USE IN GUARANTEED SYSTEMS: Up to 15 Years

EVERGUARD® EPDM
Roof Edge – Gutter

September 2002
Interim Updates at www.gaf.com

ERE-2

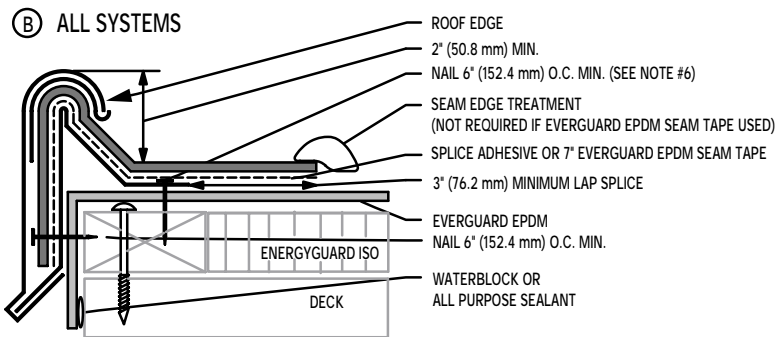
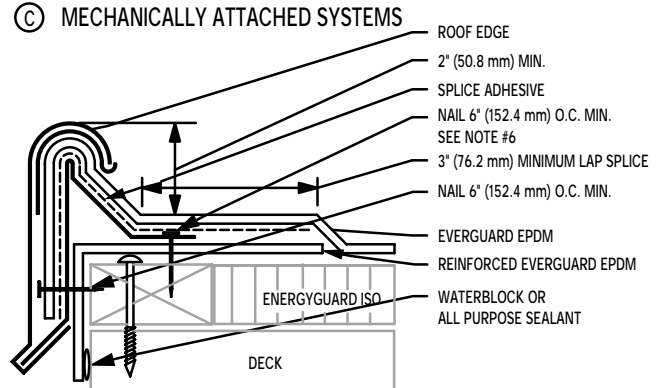
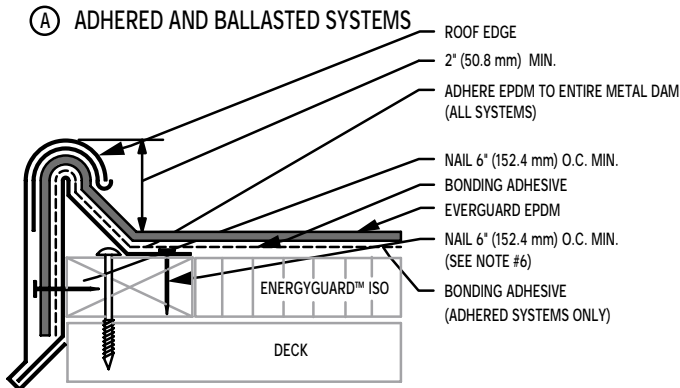

NOTES:

1. REFER TO ROOF EDGE INSTALLATION INSTRUCTIONS.
2. REFER TO DETAIL EBT-12 FOR EPDM JOINT COVER REQUIREMENTS.
3. EVERGUARD EPDM SEAM TAPE MAY BE USED IN LIEU OF SPLICE ADHESIVE IN CONFIGURATIONS B & C. HOWEVER, THE EVERGUARD MEMBRANE BETWEEN THE EVERGUARD EPDM SEAM TAPE AND THE BOTTOM OF THE DAM FACE MUST BE BONDED TO THE METAL DAM WITH SPLICE ADHESIVE.
4. MINIMUM DAM HEIGHT IS 2" (50.8 mm).
5. WOOD NAILER MUST EXTEND BEYOND METAL FLANGE IN ALL DIRECTIONS.
6. FOR GENERIC SNAP-ON EDGE METAL, THE FASTENING DENSITY FOR THE METAL DAM IS INCREASED TO MAXIMUM OF 4" (101.6 mm) O.C.

SYSTEMS: As Noted
FOR USE IN GUARANTEED SYSTEMS: Up to 15 Years

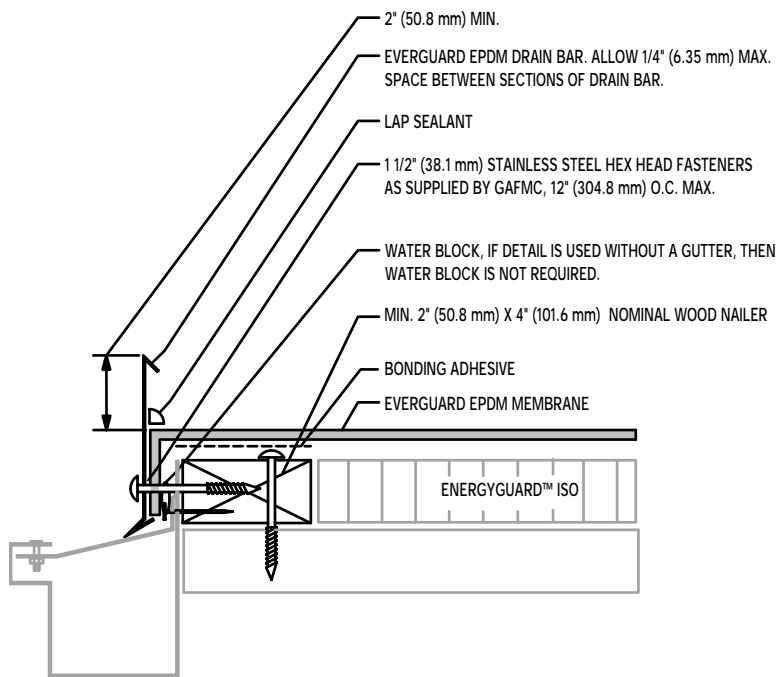

GUTTER (BY OTHERS). ROUND ALL METAL CORNERS.
 PLACE BACK OF GUTTER STRAP 1/4" (6.35 mm)
 BELOW TOP OF WOOD NAILER.

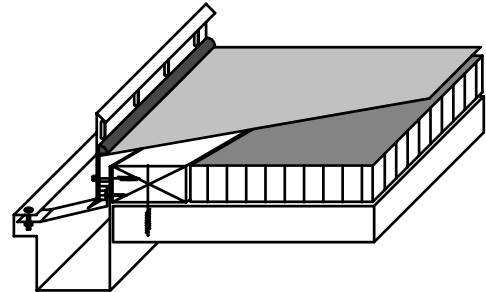

NOTES:

1. DO NOT PRE-NAIL MEMBRANE TO THE FACE OF THE WOOD NAILER.
2. ANCHOR GUTTER IN ACCORDANCE WITH SMACNA RECOMMENDATIONS.

SYSTEMS: Adhered, Ballasted
 FOR USE IN GUARANTEED SYSTEMS: Up to 15 Years

EVERGUARD® EPDM
 Drain Bar

September 2002
 Interim Updates at www.gaf.com

ERE-4

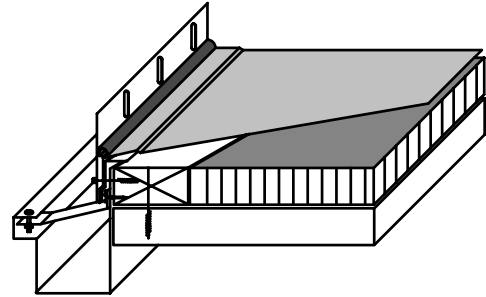
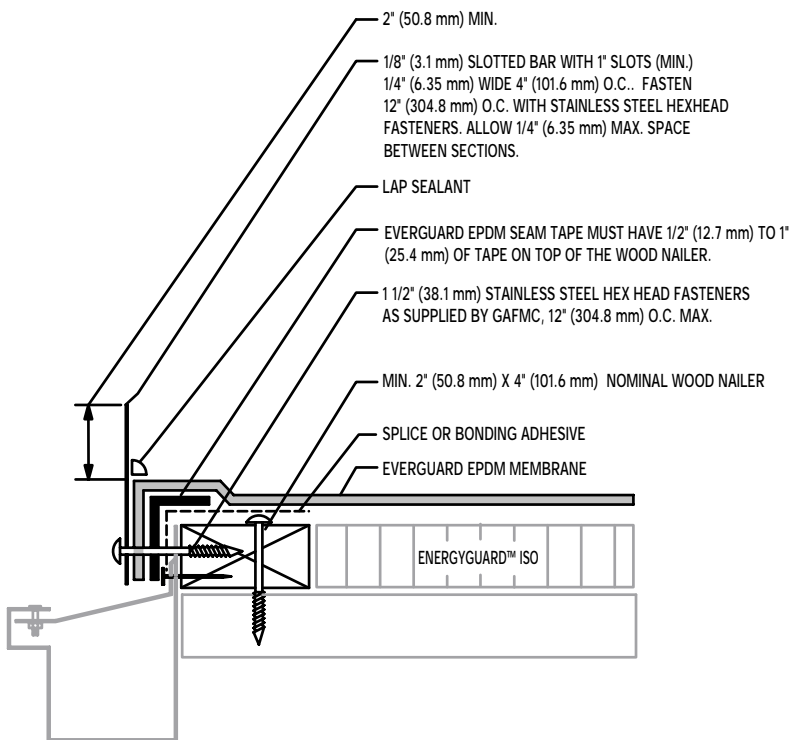

GUTTER (BY OTHERS). ROUND ALL METAL CORNERS.

PLACE BACK OF GUTTER STRAP 1/4" (6.35 mm)
BELOW TOP OF WOOD NAILER. ANCHOR GUTTER IN ACCORDANCE WITH SMACNA RECOMMENDATIONS.

SYSTEMS: Adhered, Ballasted
FOR USE IN GUARANTEED SYSTEMS: Up to 15 Years

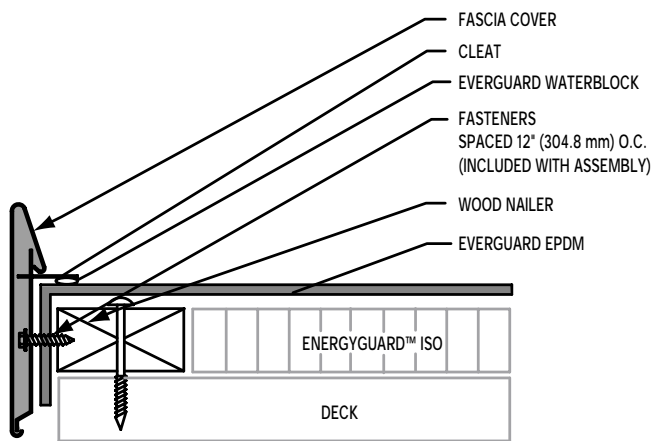
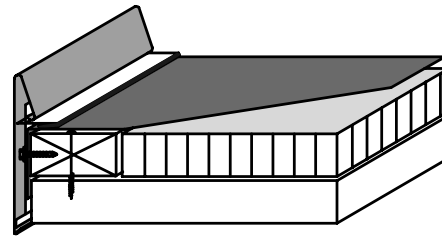

CLEAT CONFIGURATION FOR ADHERED ROOF SYSTEMS

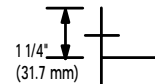

CLEAT CONFIGURATION FOR BALLASTED ROOF SYSTEMS

SYSTEMS: Adhered, Ballasted
 FOR USE IN GUARANTEED SYSTEMS: Up to 15 Years

EVERGUARD® EPDM
 Pre-Manufactured Metal Edge

September 2002
 Interim Updates at www.gaf.com

ERE-6

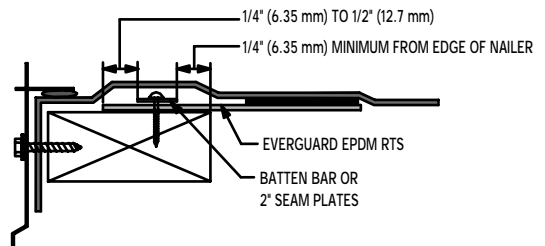
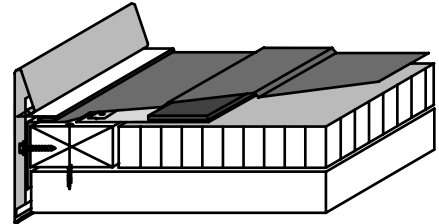
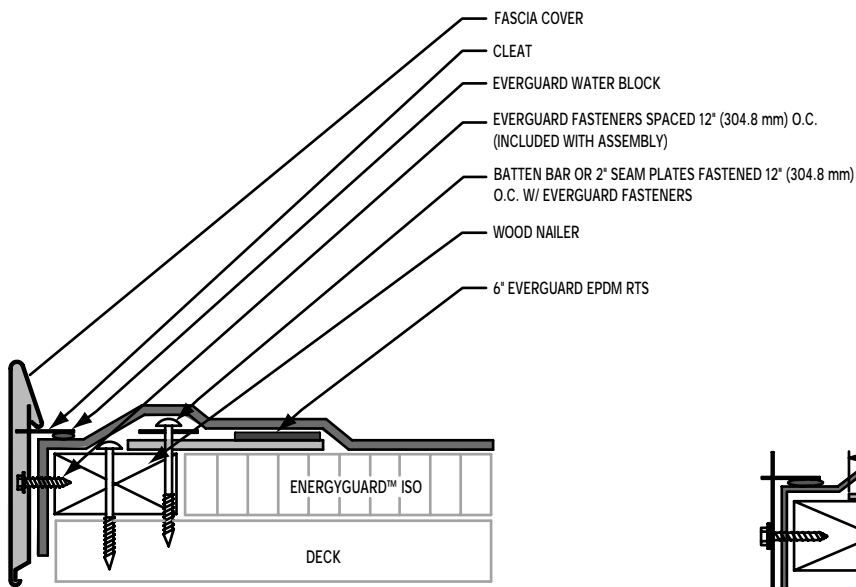

SYSTEMS: Mechanically Attached
 FOR USE IN GUARANTEED SYSTEMS: Up to 15 Years

ERE-7

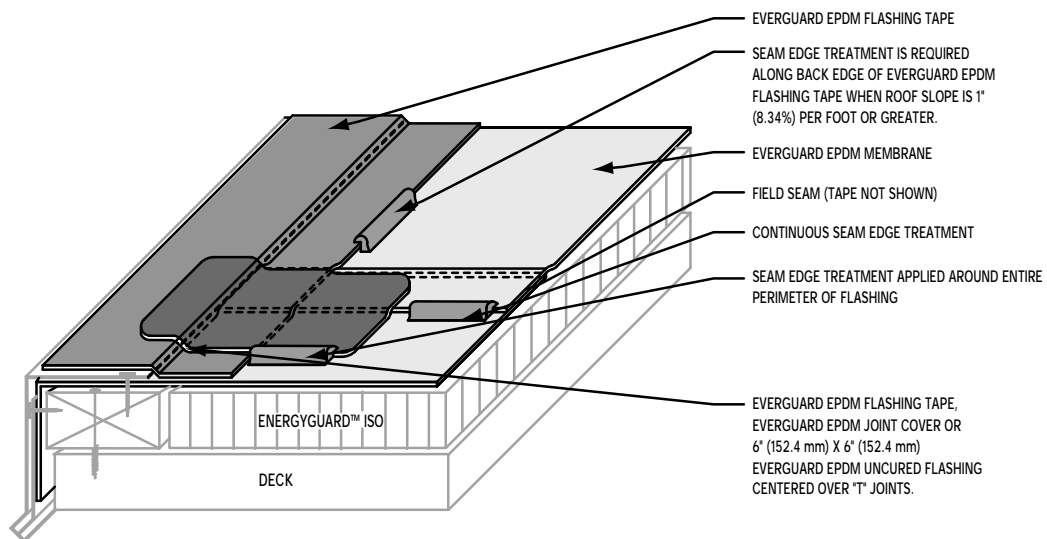

SYSTEMS: ALL
 FOR USE IN GUARANTEED SYSTEMS: Up to 15 Years

EVERGUARD® EPDM
 Roof Edge with EverGuard EPDM Flashing Tape at Field Seam

September 2002
 Interim Updates at www.gaf.com

ERE-8

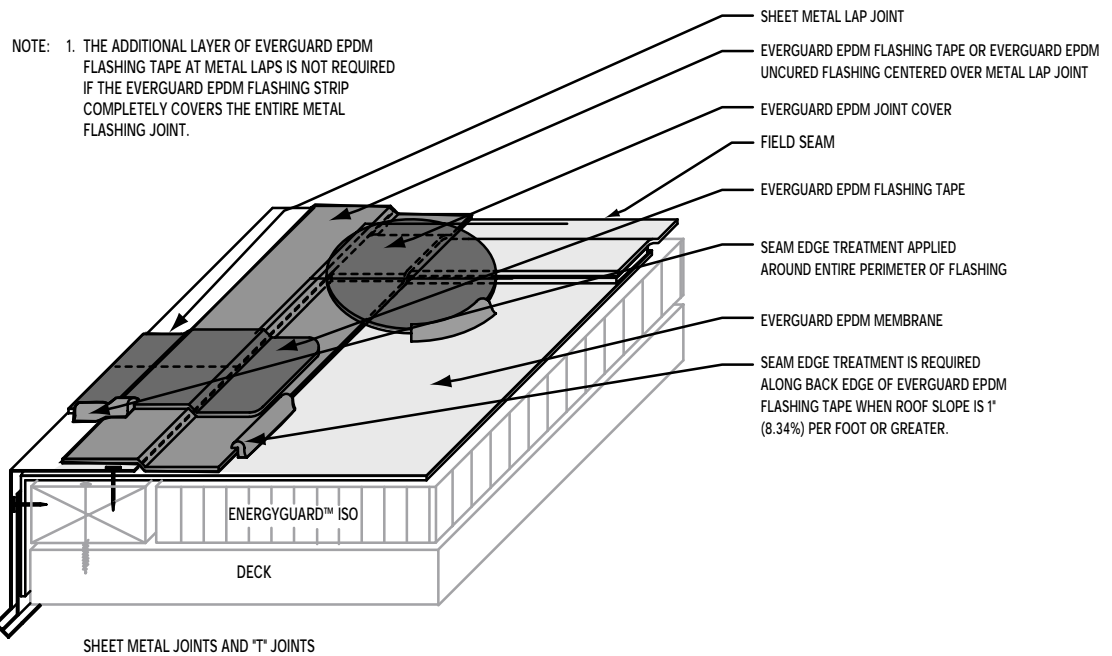

SYSTEMS: ALL
 FOR USE IN GUARANTEED SYSTEMS: Up to 15 Years

ERE-9

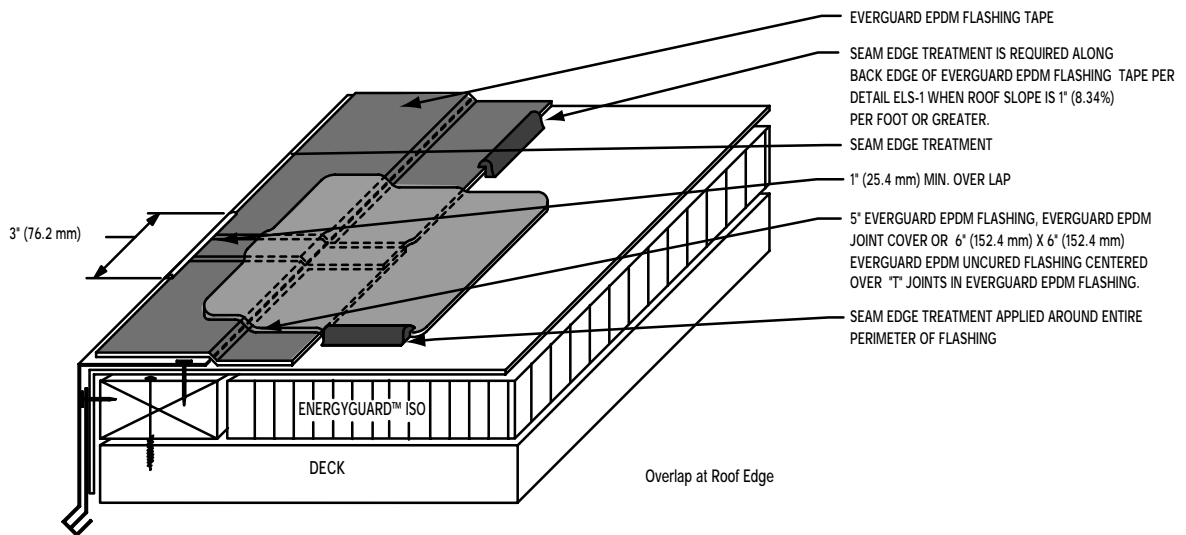

SYSTEMS: ALL
FOR USE IN GUARANTEED SYSTEMS: Up to 20 Years

EVERGUARD® EPDM
Overlap at Roof Edge

September 2002
Interim Updates at www.gaf.com

ERE-10

15

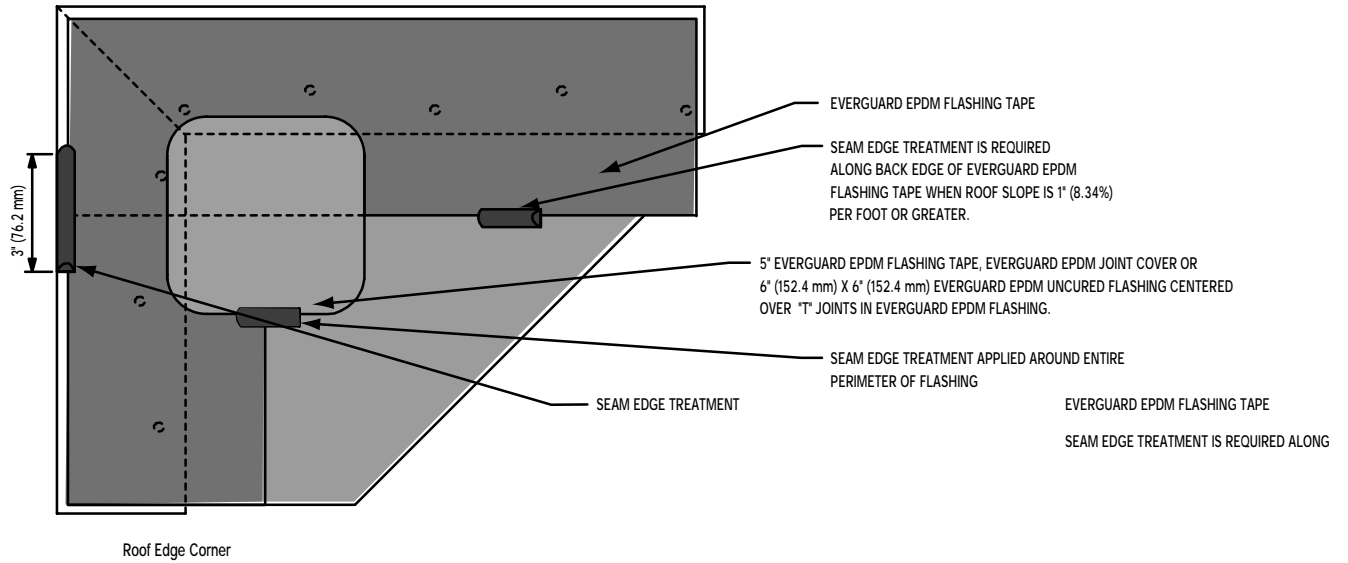

SYSTEMS: ALL
FOR USE IN GUARANTEED SYSTEMS: Up to 20 Years

ERE-11