

EverGuard® EPDM Table of Contents System Details

Details No.	EverGuard EPDM	Systems
	Drains And Scuppers	
ED-1	Drain Flashing	All
ED-2	Drain Insert	All
ES-1	Scupper	All
ES-2	Overflow Scupper	All

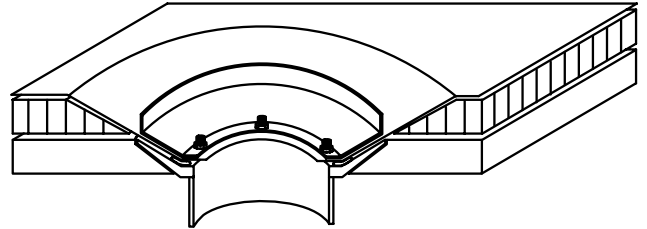

OPTION B (FOR USE WITH REINFORCED MEMBRANE IN SUMPS SLOPED GREATER THAN 1:12 (8.34%))

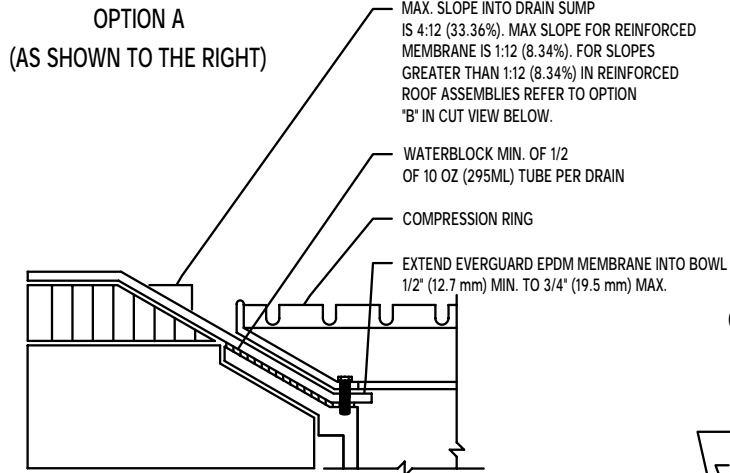
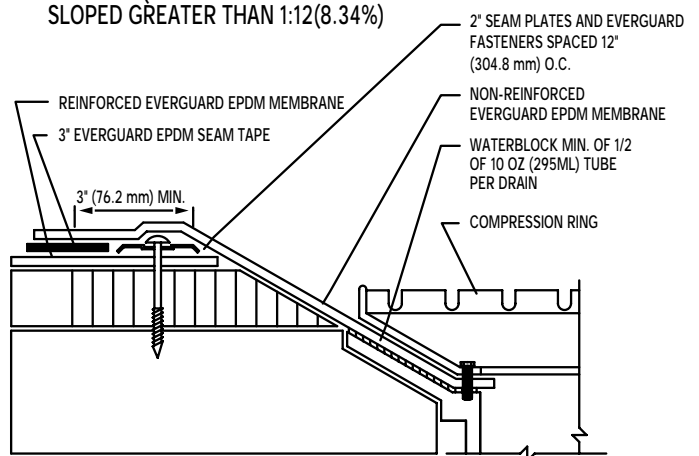

NOTES:

1. IF SEAMS RUN WITHIN 18" (457.2 mm) OF DRAIN, INSTALL A 4' (1.2M) X 4' (1.2M) MIN. EPDM PATCH ON TOP OF MEMBRANE ASSURING SEAM IS COVERED. AS AN ALTERNATE, FLASH THE SEAM WITH 6" EVERGUARD EPDM UNCURED FLASHING EXTENDING 3" (76.2 mm) MIN. ON TO HORIZONTAL ROOF SURFACE.
2. TAPERED INSULATION WITH APPROPRIATE BONDING SURFACE SHALL BE USED WITH FULLY ADHERED SYSTEMS.
3. IN REROOF APPLICATIONS:
 - A. REMOVE EXISTING FLASHINGS DOWN TO METAL SUMP.
 - B. REPAIR OR REPLACE BROKEN CLAMPING RING.
 - C. DRILL AND TAP BROKEN DRAIN BOLTS AND REPLACE.

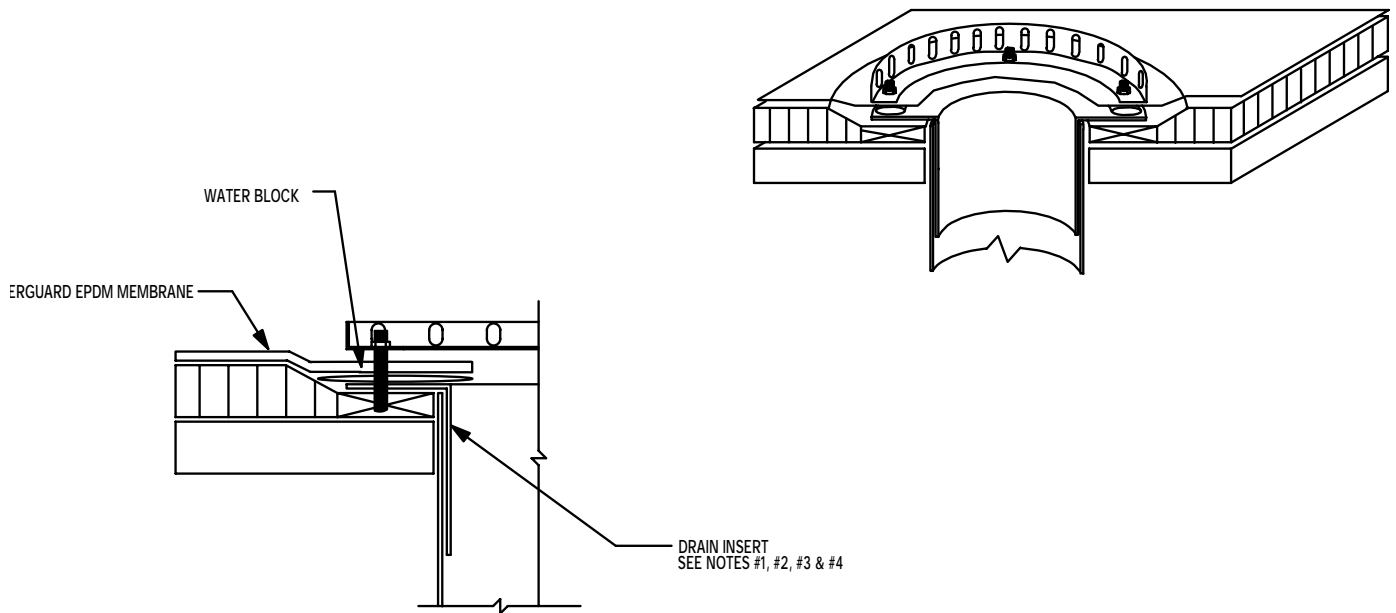

NOTES:

1. WHEN USED ON A MECHANICALLY ANCHORED ROOF SYSTEM ADDITIONAL MEMBRANE SECUREMENT IS REQUIRED 24" (609.6 mm) FROM DRAIN IN ALL DIRECTIONS. THIS CAN BE ACCOMPLISHED WITH A BATTEN BAR PICTURE FRAME SECURED 12" (304.8 mm) O.C. WITH EVERGUARD FASTENERS AND STRIPPED IN WITH EVERGUARD EPDM BATTEN COVER.
2. WOOD NAILER MUST EXTEND BEYOND METAL FLANGE IN ALL DIRECTIONS.
3. INSERT SHALL EXTEND MINIMUM 3" (76.2 mm) INTO DRAIN PIPE BEYOND SEAL OF EXISTING DRAIN AND SEAL TO INTERIOR OF PIPE BY MEANS OF A MECHANICAL SEAL. A MECHANICAL SEAL IS ACHIEVED BY EITHER EXPANDING A MALLEABLE INSERT TUBE IN A BED OF SEALANT TO FORM A COMPRESSION SEAL TO THE PLUMBING PIPE OR BY A MECHANICAL EXPANSION DEVICE ATTACHED TO THE INSERT TUBE. IN EITHER CASE THE PERFORMANCE OF THE INSERT IS THE RESPONSIBILITY OF THE SPECIFIER AND COMPONENT MANUFACTURER.
4. DECK FLANGE MUST EXTEND THREE INCHES BEYOND DROP OPENING IN ALL DIRECTIONS.
5. COMPRESSION RING MUST BE MINIMUM 1" (25.4 mm) WIDE WITH DULL EDGES AND INCLUDE A COVER BASKET AS WELL AS BALLAST RETENTION WHEN USED IN A BALLASTED ROOF SYSTEM.

SYSTEMS: ALL
FOR USE IN GUARANTEED SYSTEMS: Up to 15 Years

EVERGUARD® EPDM
Drain Insert

September 2002
Interim Updates at www.gaf.com

ED-2

61

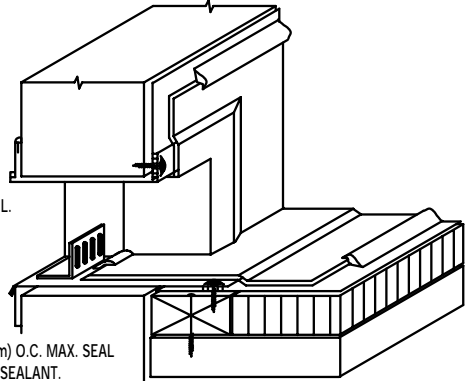
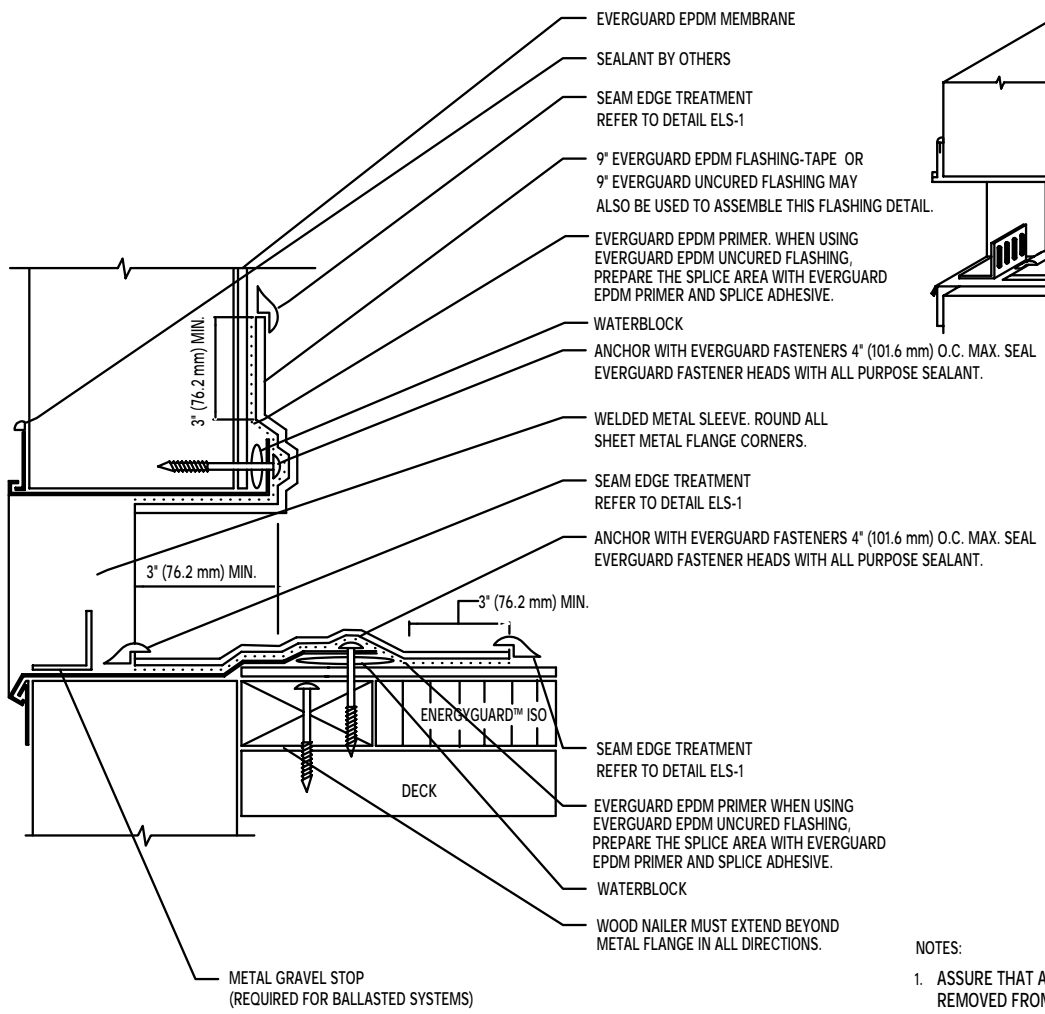

- NOTES:
1. ASSURE THAT ALL OILS AND CONTAMINANTS ARE REMOVED FROM METAL SURFACES BEFORE SPLICING.
 2. REFER TO ARCHITECT'S PLANS & SPECIFICATIONS FOR SCUPPER DIMENSIONS; WHEN UNAVAILABLE REFER TO SMACNA RECOMMENDATIONS.

SYSTEMS: ALL
FOR USE IN GUARANTEED SYSTEMS: Up to 15 Years

ES-1

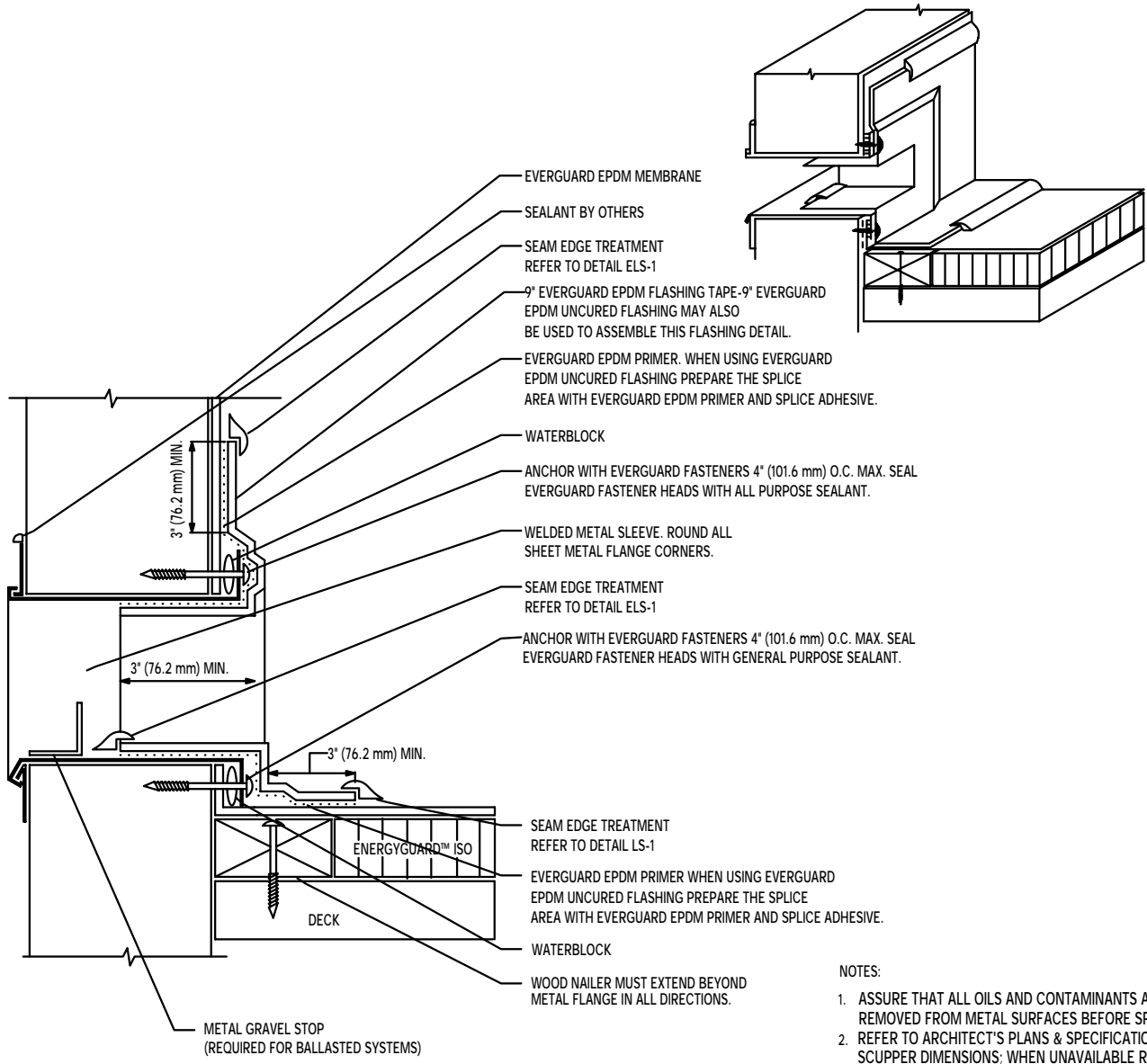

- NOTES:
1. ASSURE THAT ALL OILS AND CONTAMINANTS ARE REMOVED FROM METAL SURFACES BEFORE SPLICING.
 2. REFER TO ARCHITECT'S PLANS & SPECIFICATIONS FOR SCUPPER DIMENSIONS; WHEN UNAVAILABLE REFER TO SMACNA RECOMMENDATIONS.

SYSTEMS: ALL
 FOR USE IN GUARANTEED SYSTEMS: Up to 15 Years
 EVERGUARD® EPDM
 Overflow Scupper

September 2002
 Interim Updates at www.gaf.com