

TriPosit®
Wall Flashing With Coated Metal Edge
TRI 304

Diagram

Updated: 11/06



*Quality You Can Trust Since 1886...
From North America's Largest Roofing Manufacturer™*

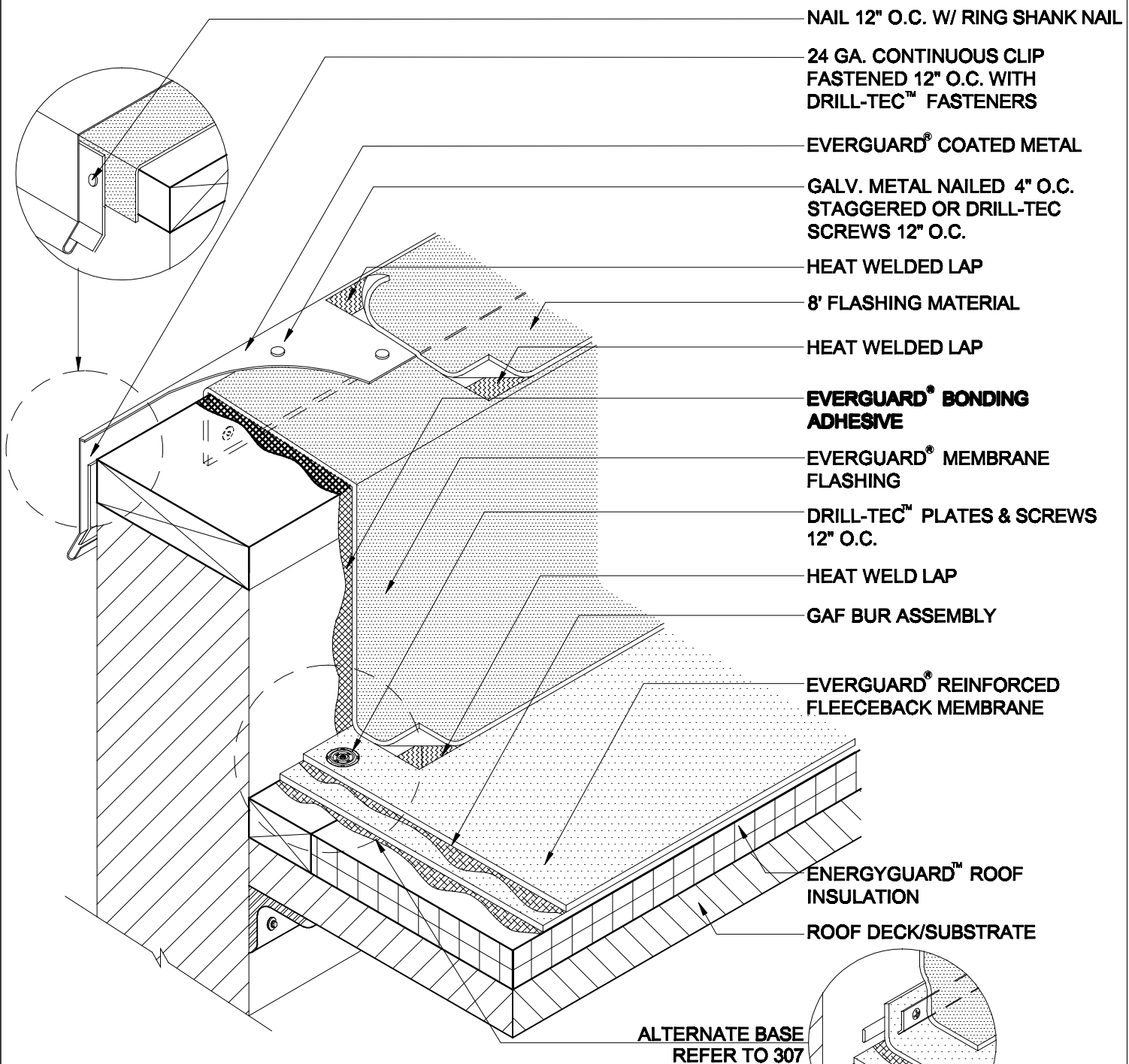

- NAIL 12" O.C. W/ RING SHANK NAIL
- 24 GA. CONTINUOUS CLIP FASTENED 12" O.C. WITH DRILL-TEC™ FASTENERS
- EVERGUARD® COATED METAL
- GALV. METAL NAILED 4" O.C. STAGGERED OR DRILL-TEC SCREWS 12" O.C.
- HEAT WELDED LAP
- 8' FLASHING MATERIAL
- HEAT WELDED LAP
- EVERGUARD® BONDING ADHESIVE
- EVERGUARD® MEMBRANE FLASHING
- DRILL-TEC™ PLATES & SCREWS 12" O.C.
- HEAT WELD LAP
- GAF BUR ASSEMBLY
- EVERGUARD® REINFORCED FLEECEBACK MEMBRANE
- ENERGYGUARD™ ROOF INSULATION
- ROOF DECK/SUBSTRATE

ALTERNATE BASE
REFER TO 307

NOTE:

1. FOR INSULATION THICKNESS GREATER THAN 8", CONTACT GAFMC CONTRACTOR SERVICES FOR ALTERNATE MEMBRANE ATTACHMENT REQUIREMENTS.
2. APPLY EVERGUARD® TPO CUT EDGE SEALANT TO ALL TPO REINFORCED CUT EDGES (REFER TO DETAIL MA/FA/BA 115).



**WALL FLASHING WITH COATED METAL
EDGE**

DRAWING #
TRI 304

SCALE: N.T.S. ISSUE/ REVISION DATE: 11-01-06