

TriPosite®
Post Target
TRI 520

Diagram

Updated: 11/06



*Quality You Can Trust Since 1886...
From North America's Largest Roofing Manufacturer™*

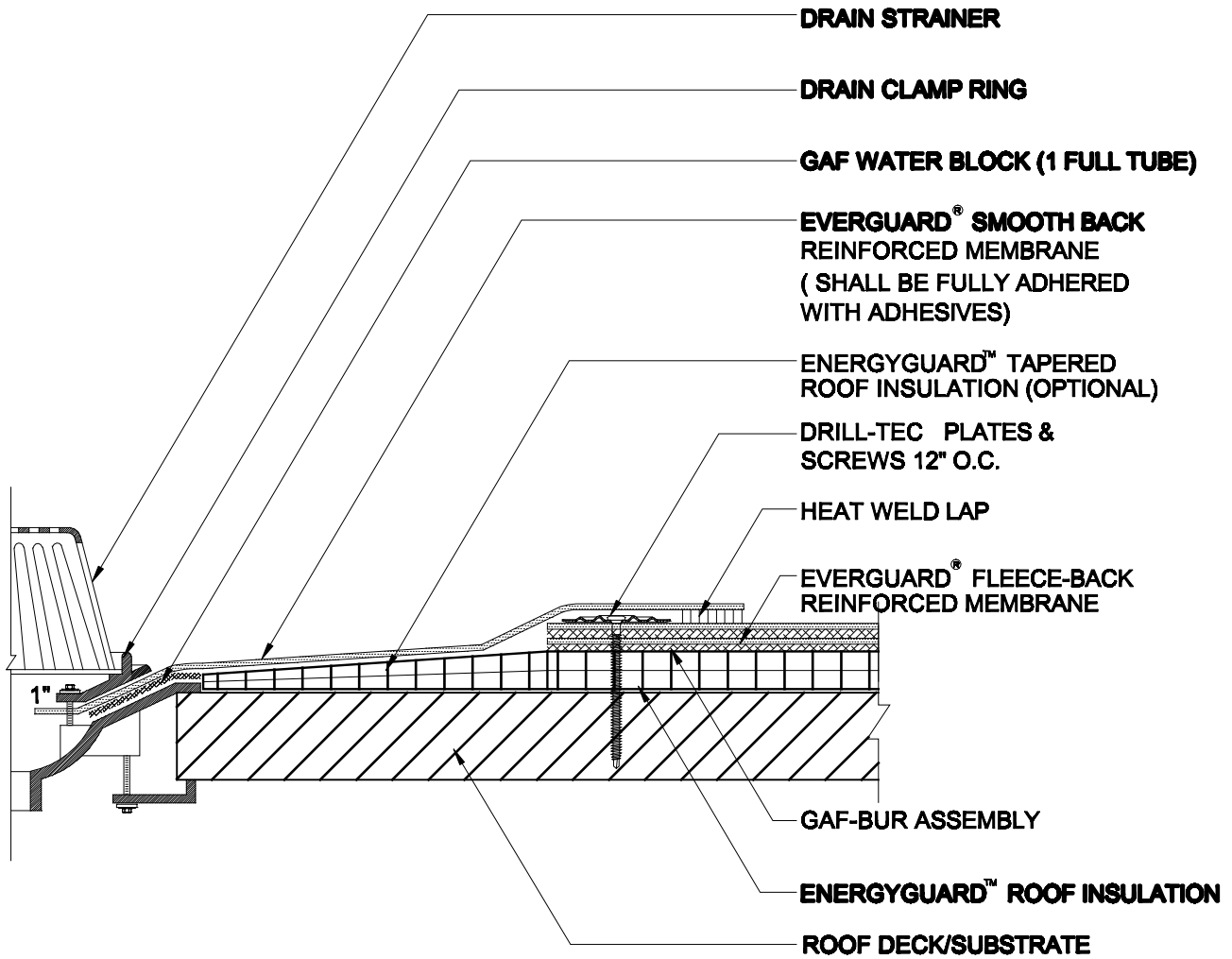

NOTE:

1. A FIELD WELD CANNOT PASS WITHIN 9" OF THE CLAMPING , OR WITHIN THE DRAIN SUMP ITSELF.
2. MEMBRANE MUST EXTEND MINIMUM 1" BEYOND THE BOLT HOLES, THE CLAMPING RING BOLTS MUST PENETRATE THE MEMBRANE.
3. TAPERED INSULATION TO CREATE A ROOF SUMP MINIMUM 36" X 36" IN SIZE (OPTIONAL).
4. GAF ASHALTIC SYSTEMS SHALL NOT RUN IN TO THE FULLY ADHERED EVERGUARD REINFORCED SMOOTHBACK MEMBRANE AREA.
5. APPLY EVERGUARD® CUT EDGE SEALANT TO ALL CUT REINFORCED TPO EDGES (REFER TO DETAIL MA/FA/BA 115).