

TriPosite®
Tri Onto Existing BUR/SBS/APP
TRI 610

Diagram

Updated: 11/06



*Quality You Can Trust Since 1886...
From North America's Largest Roofing Manufacturer™*

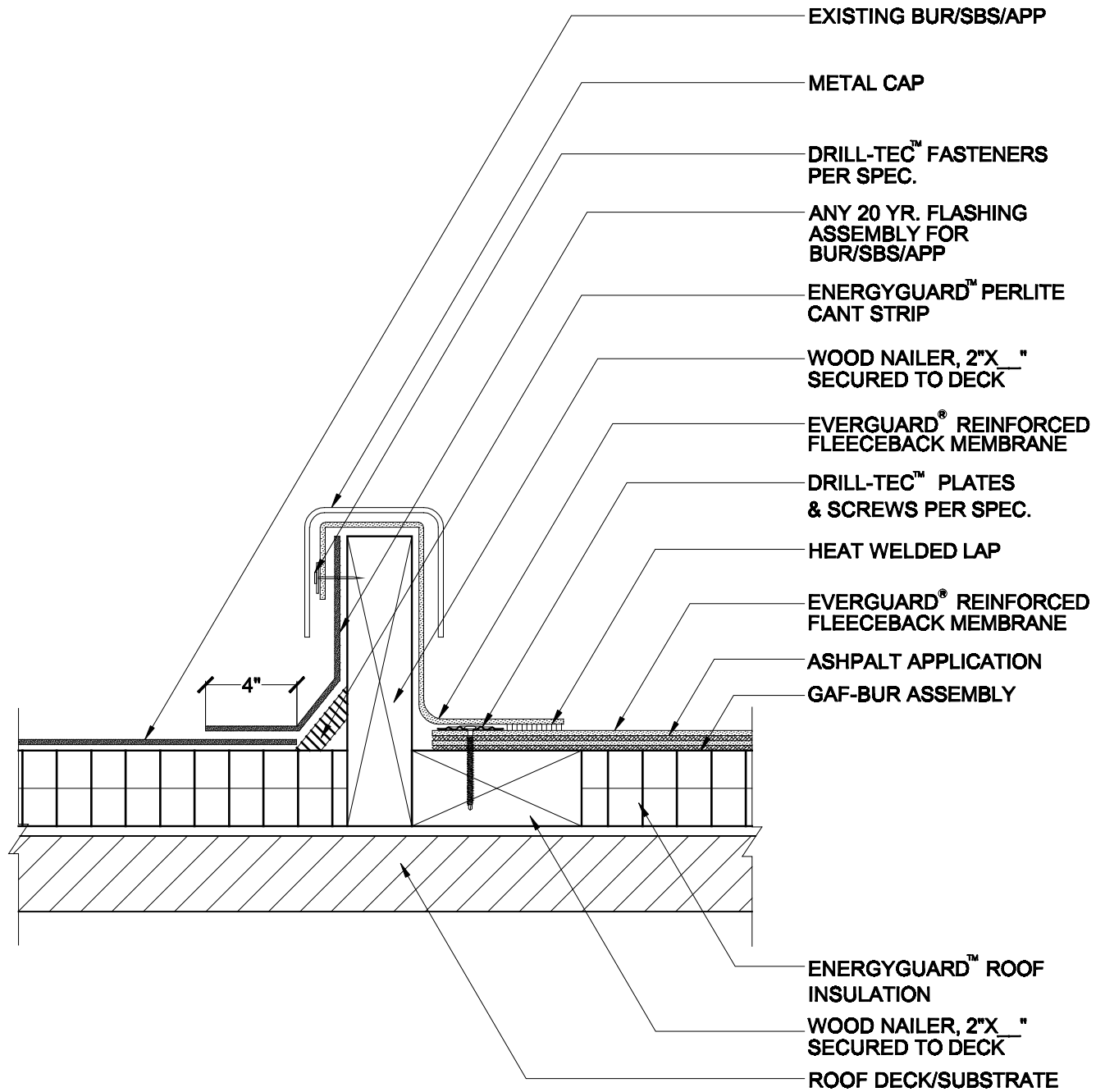

NOTE:

1. APPLY EVERGUARD® TPO CUT EDGE SEALANT TO ALL CUT REINFORCED TPO EDGES (REFER TO DETAIL MA/FA/BA 115).



TRI ONTO EXISTING BUR/ SBS/ APP

DRAWING #
TRI 610

SCALE	ISSUE/ REVISION DATE
N.T.S.	11-01-06