

EverGuard®
Field Fabricated Inside Corner
MA/FA/BA 315B

Diagram

Updated: 11/06



*Quality You Can Trust Since 1886...
From North America's Largest Roofing Manufacturer™*

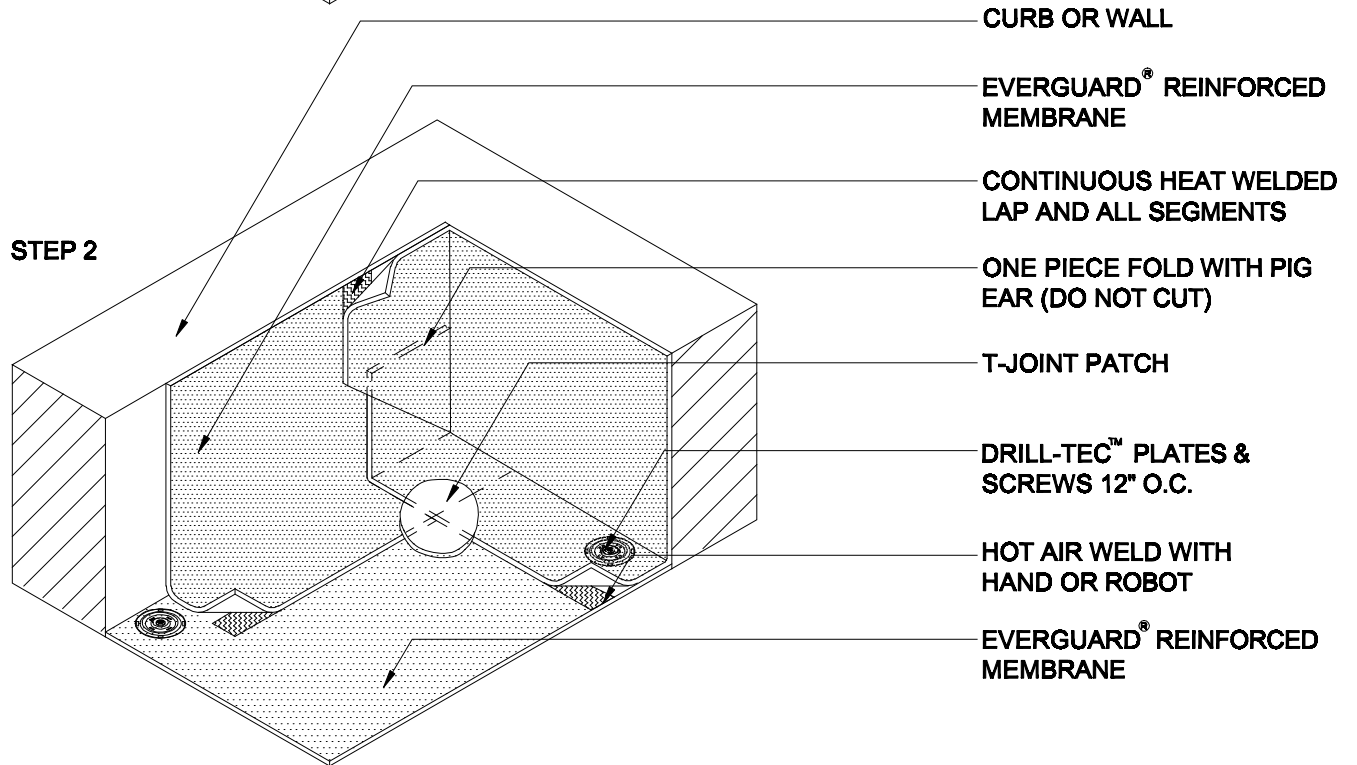
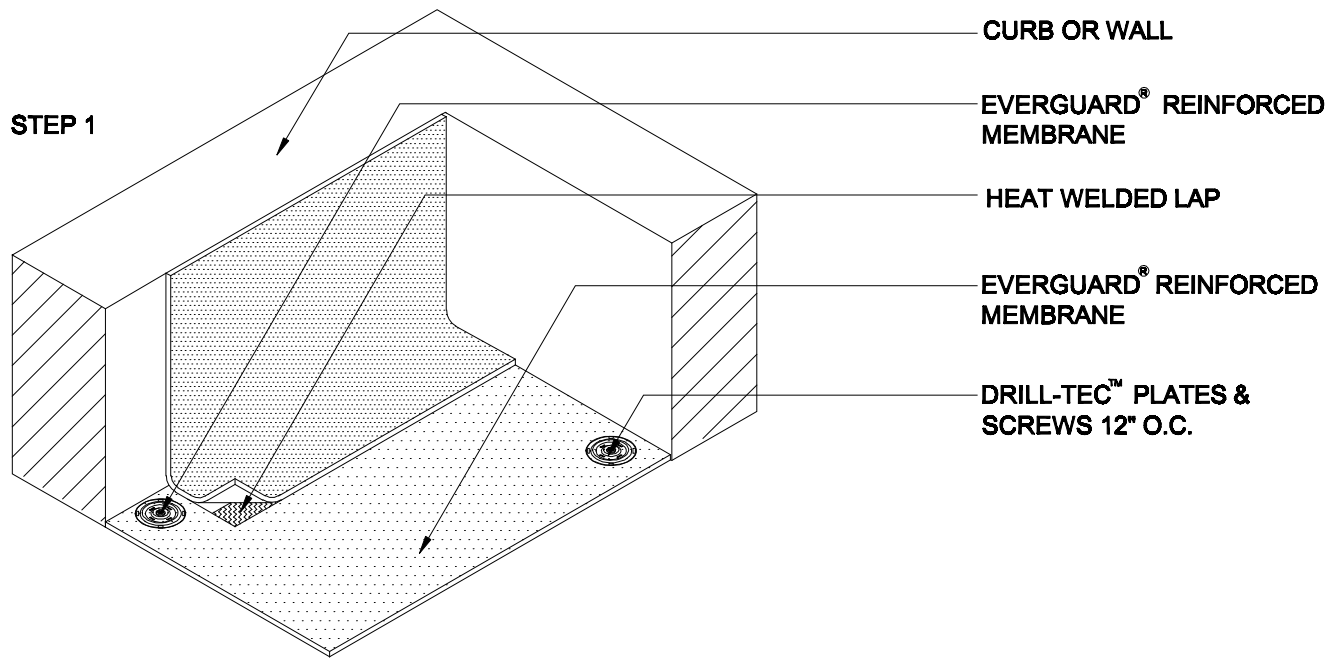

NOTE:

1. ALL SEGMENTS OF THE EAR MUST BE WELDED TOGETHER AND WELDED TO THE WALL
2. APPLY EVERGUARD® TPO CUT EDGE SEALANT TO ALL CUT REINFORCED TPO EDGES (REFER TO DETAIL MA/FA/BA 115)



FIELD FABRICATED INSIDE CORNER

DRAWING #

MA/FA/BA 315B

SCALE
N.T.S.

ISSUE/ REVISION DATE
11-01-06