

EverGuard®
Coated Metal Wall Scupper
MA/FA/BA 311

Diagram

Updated: 11/06



*Quality You Can Trust Since 1886...
From North America's Largest Roofing Manufacturer™*

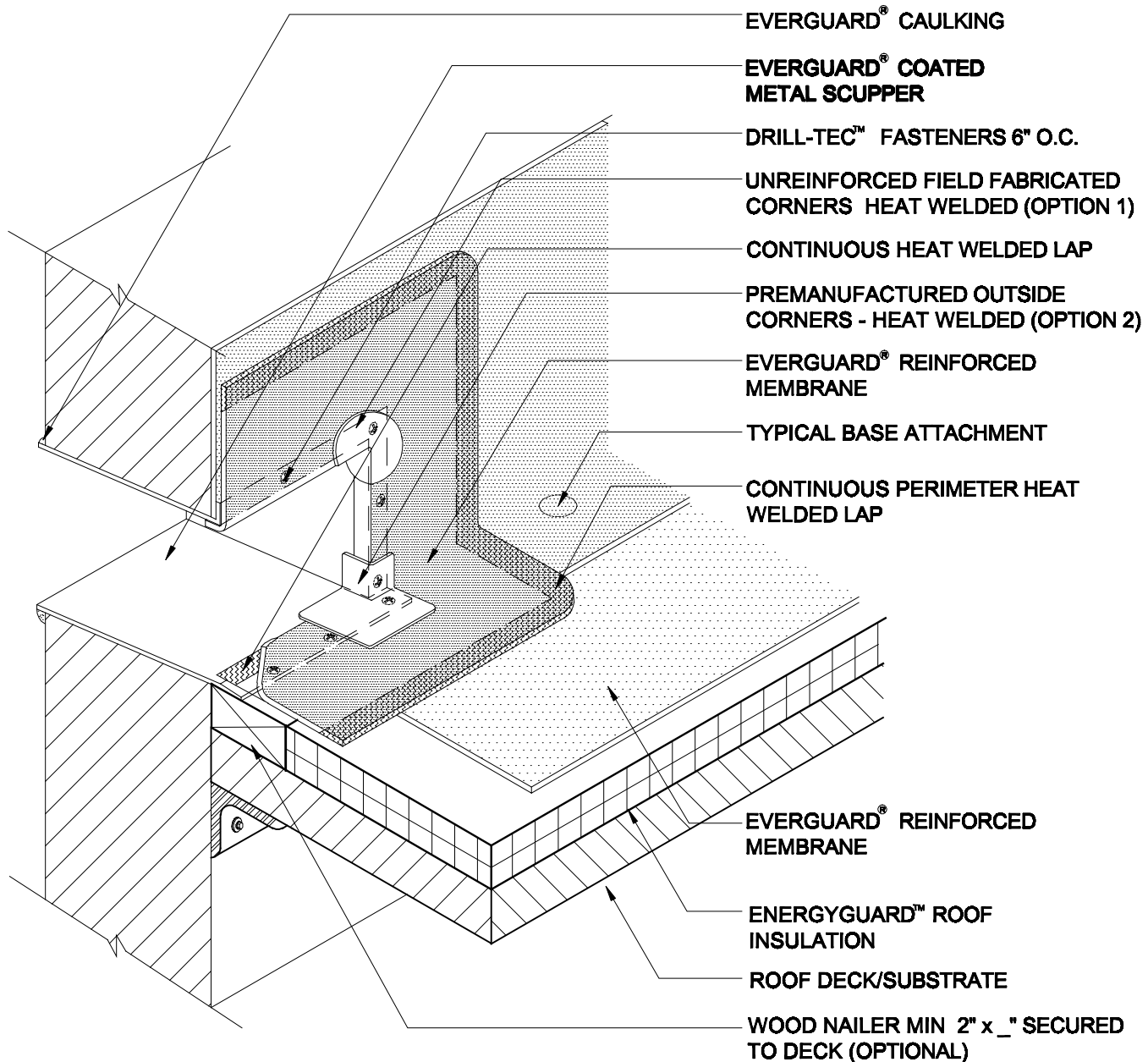

NOTE:

1. REMEMBER TO INSTALL EVERGUARD® UNREINFORCED OR PREMANUFACTURED OUTSIDE CORNERS TO THE SCUPPERS' FOUR ROOF SIDE CORNERS.
2. OPTIONS 1 & 2 EITHER PRE-FAB OR FIELD FAB.
3. PLATES & SCREWS 6" O.C. REQ'D FOR BA SYSTEMS.
4. APPLY EVERGUARD® TPO CUT EDGE SEALANT TO ALL CUT REINFORCED TPO EDGES (REFER TO DETAIL MA/FA/BA 115).



COATED METAL WALL SCUPPER

DRAWING #

MA/FA/BA 311

SCALE
N.T.S.

ISSUE/ REVISION DATE
11-01-06