

EverGuard®
Field Fabricated Expansion
Joint - Flat Type
MA/FA/BA 401B

Diagram

Updated: 7/07



*Quality You Can Trust Since 1886...
From North America's Largest Roofing Manufacturer™*

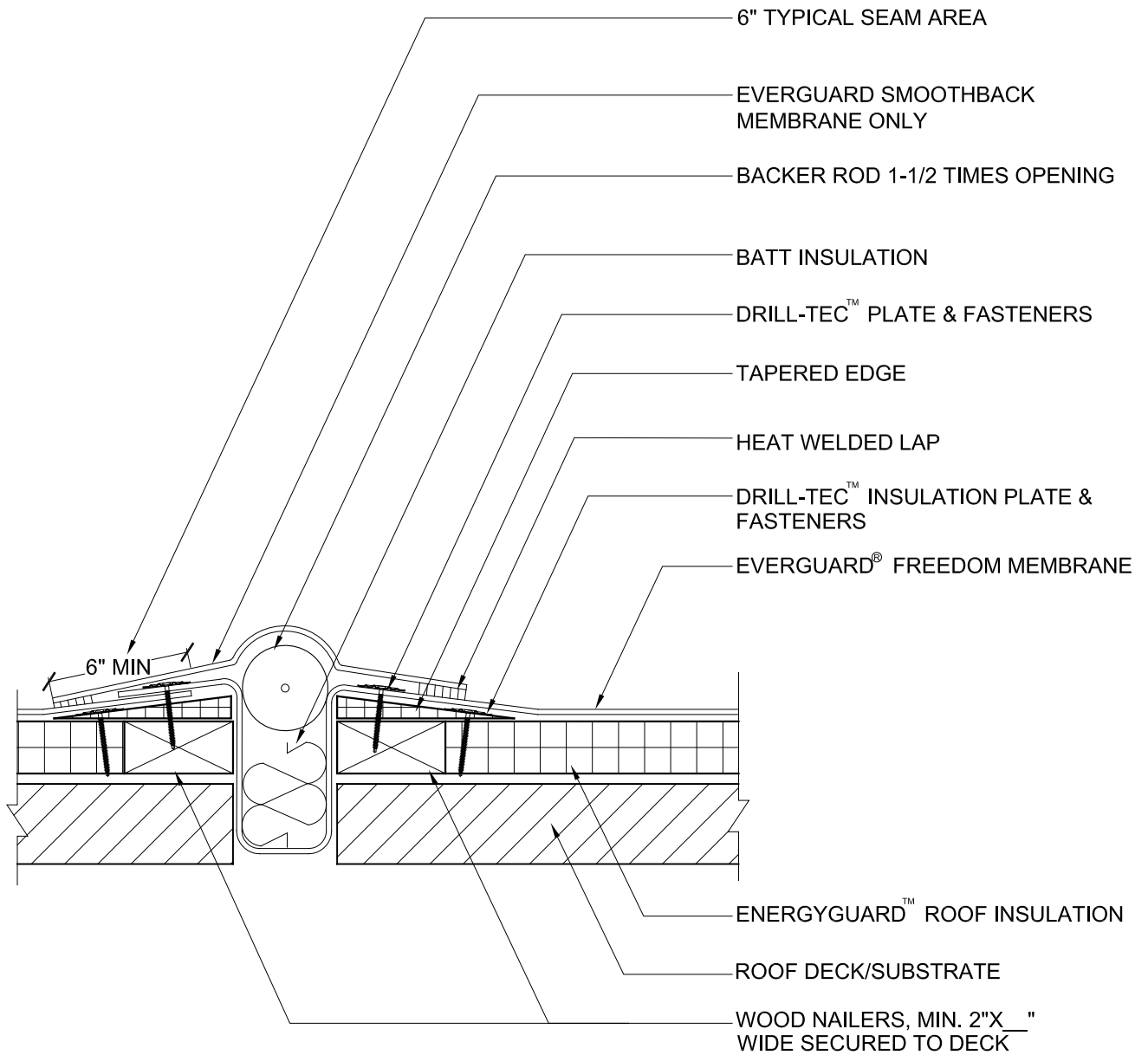

NOTE:

1. APPLY EVERGUARD[®] TPO AND PVC CUT EDGE SEALANT TO ALL CUT REINFORCED TPO AND PVC EDGES (REFER TO DETAIL MA/FA/BA 115).



**FIELD FABRICATED EXPANSION JOINT -
FLAT TYPE**

DRAWING #

MA/FA/BA 401B

SCALE	ISSUE/ REVISION DATE
N.T.S.	7-01-07