

EverGuard®
Metalastic Expansion
Joint - Flat Type
MA/FA/BA 401C

Diagram

Updated: 7/07



*Quality You Can Trust Since 1886...
From North America's Largest Roofing Manufacturer™*

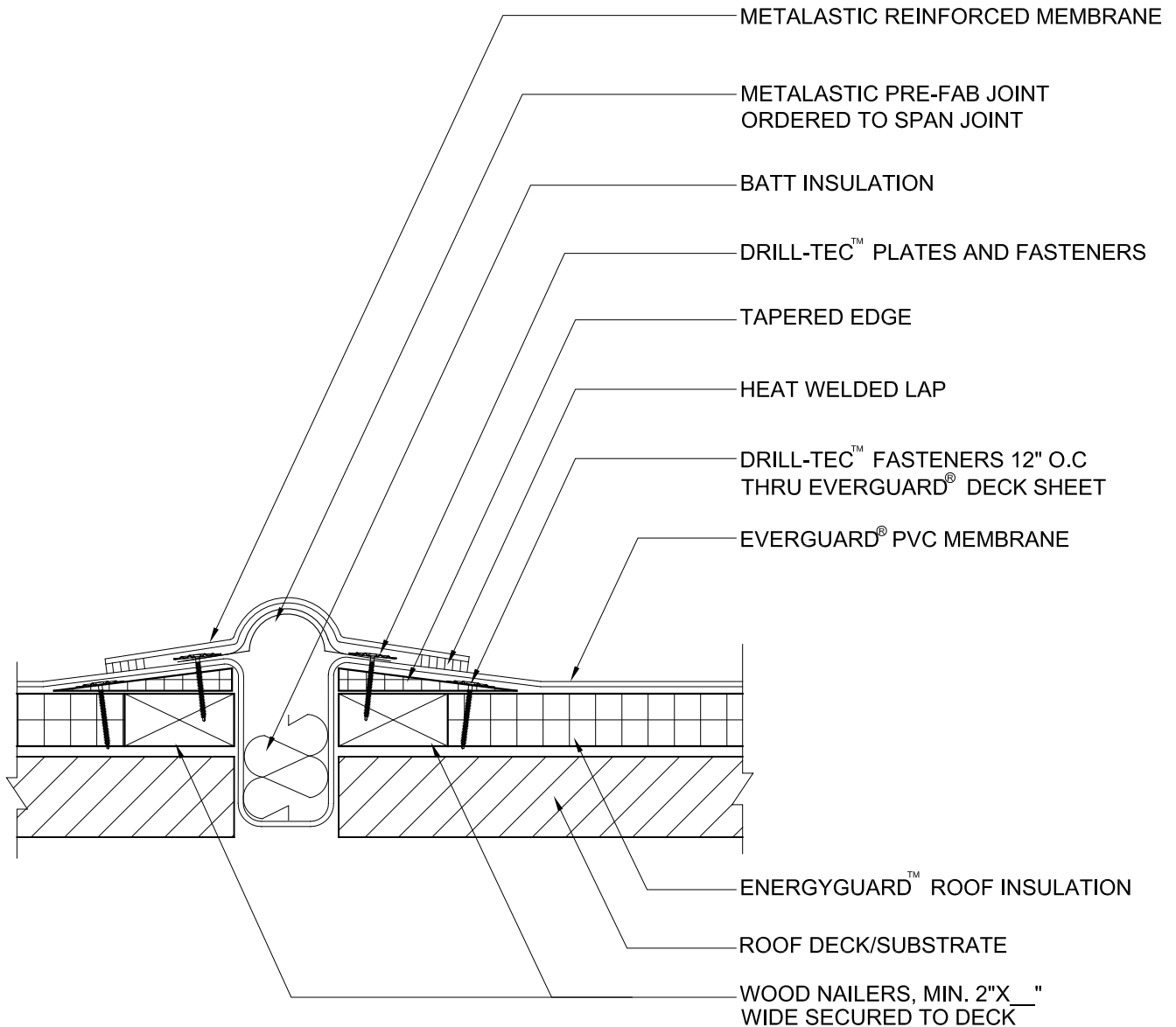

NOTE:

1. FOR PVC ONLY
5. APPLY EVERGUARD® PVC CUT EDGE SEALANT TO ALL CUT REINFORCED PVC EDGES (REFER TO DETAIL MA/FA/BA 115).



METALASTIC EXPANSION JOINT - FLAT TYPE

PVC ONLY

DRAWING #

MA/FA/BA 401C

SCALE

N.T.S.

ISSUE/ REVISION DATE

7-01-07