

EverGuard®
Factory Fabricated Expansion
Joint Detail - Curb Type
MA/FA/BA 402A

Diagram

Updated: 8/07



*Quality You Can Trust Since 1886...
From North America's Largest Roofing Manufacturer™*

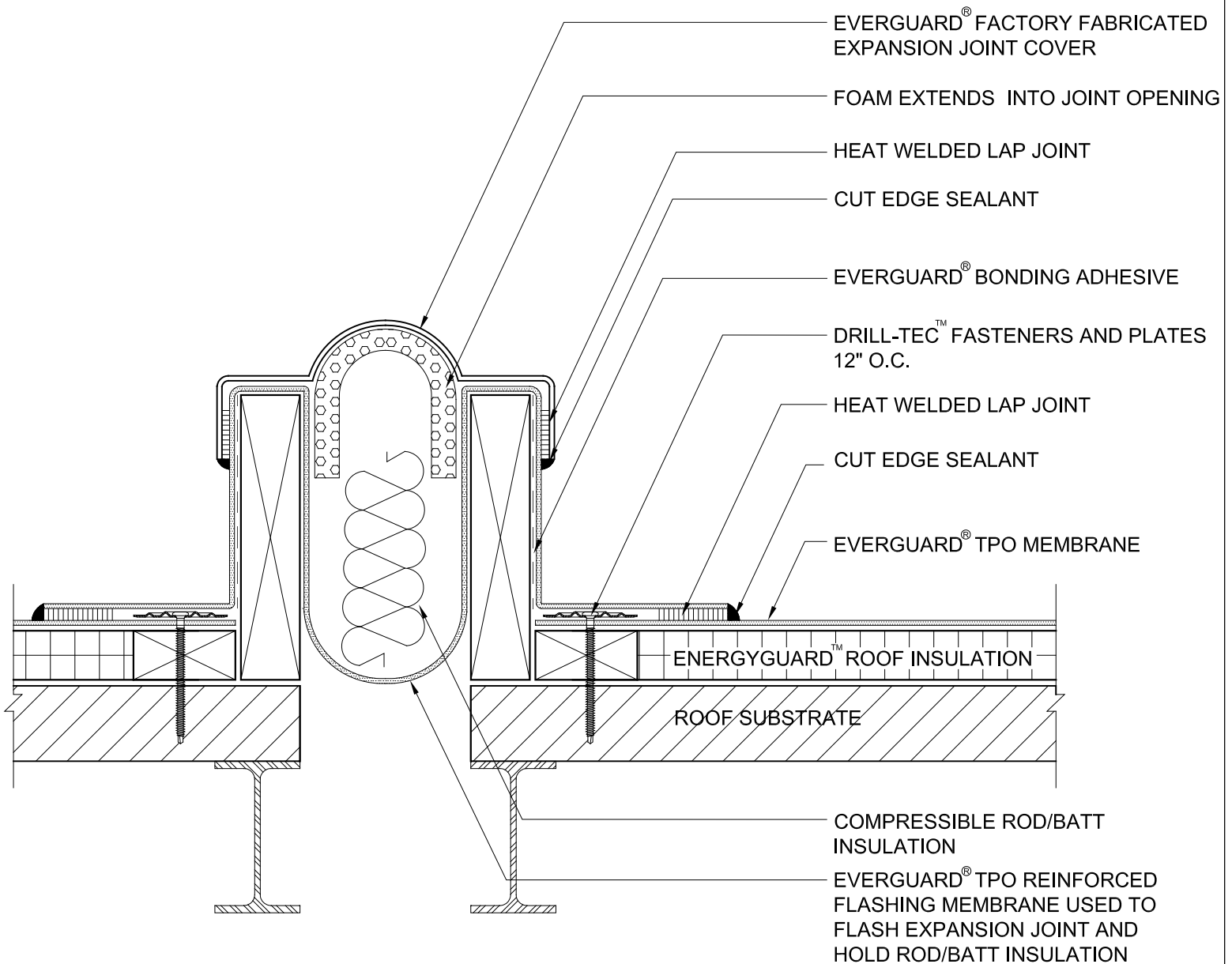

NOTE:

1. ALL FLASHINGS ON EXPANSION JOINTS MUST BE ADHERED.
2. APPLY EVERGUARD® TPO CUT EDGE SEALANT TO ALL CUT REINFORCED TPO EDGES (REFER TO DETAIL MA/FA/BA 115).