

EverGuard®
Termination at RTU with Welded Lap
MA/FA/BA 503A

Diagram

Updated: 4/09



*Quality You Can Trust Since 1886...
From North America's Largest Roofing Manufacturer™*

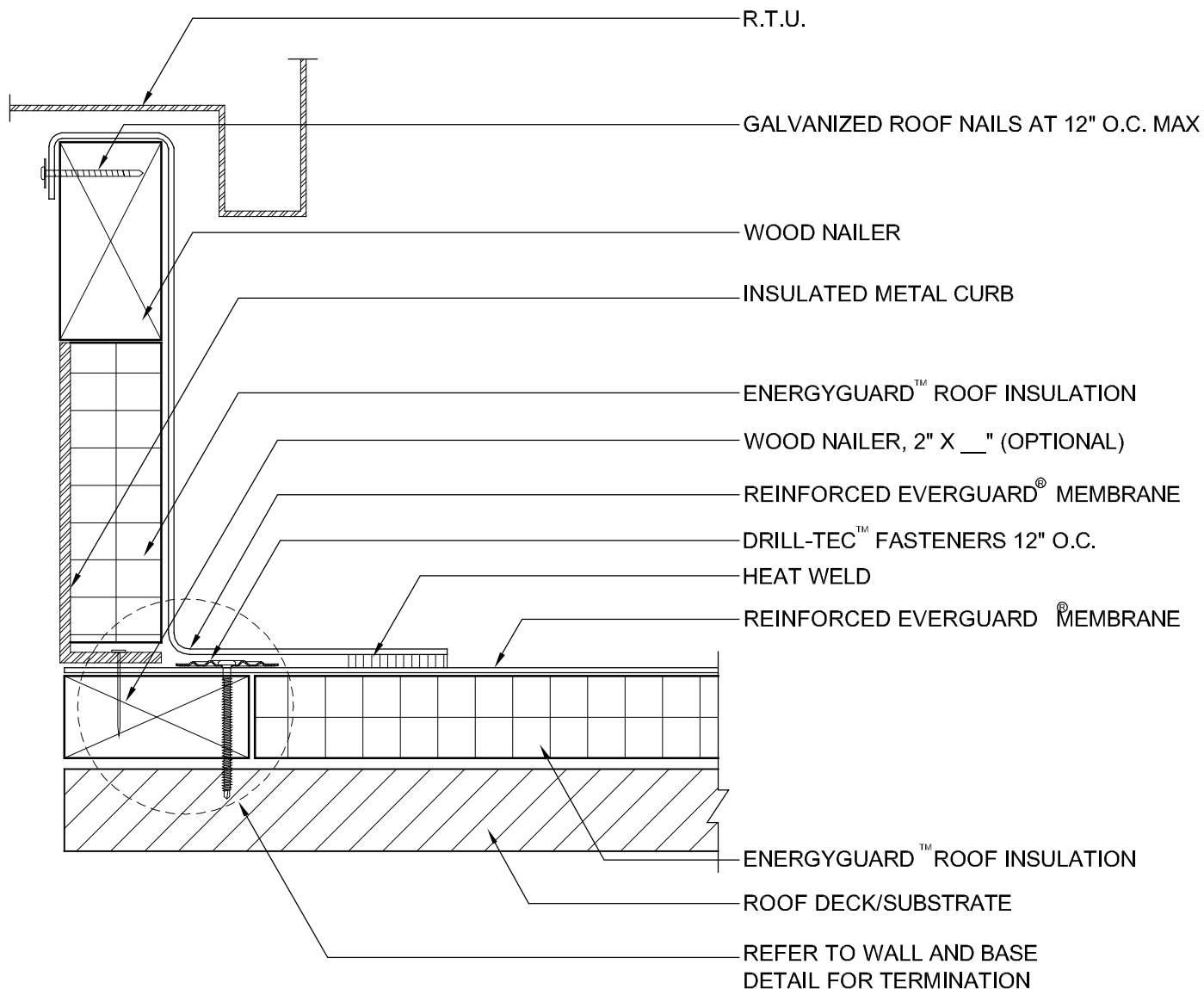

NOTE:

1. PLATES & SCREWS 6" O.C. REQ'D FOR BA SYSTEM.
2. APPLY EVERGUARD® TPO AND PVC CUT EDGE SEALANT TO ALL CUT REINFORCED TPO AND PVC EDGES (REFER TO DETAIL MA/FA/BA 115).



ROOF PENETRATION
SERIES

TERMINATION AT R.T.U. WITH
WELDED LAP

DRAWING #

503A

SCALE

N.T.S.

SYSTEM

MA/FA/BA

ISSUE/ REVISION DATE

4-01-09