

EverGuard®  
Termination at Sloped Roof  
MA/FA/BA 601

Diagram

Updated: 11/06



*Quality You Can Trust Since 1886...  
From North America's Largest Roofing Manufacturer™*

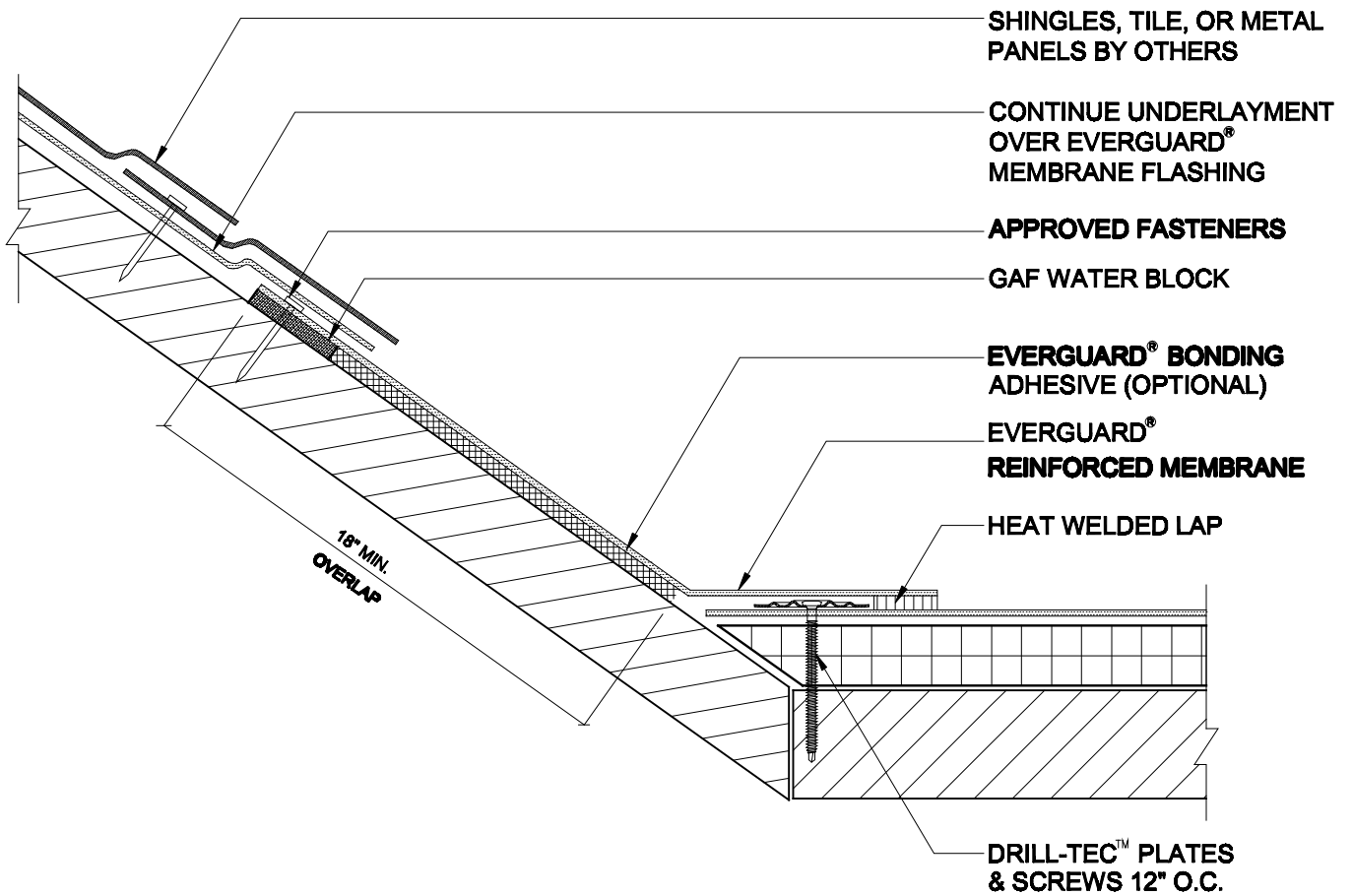

**NOTE:**

1. MINIMUM SLOPE IS 2:12.
2. FOR INSULATION THICKNESS GREATER THAN 8" CONTACT GAFMC CONTRACTOR SERVICES FOR ALTERNATE MEMBRANE ATTACHMENT REQUIREMENTS.
3. APPLY EVERGUARD® TPO CUT EDGE SEALANT TO ALL CUT REINFORCED TPO EDGES ( REFER TO DETAIL MA/FA/BA 115 ).



**TERMINATION AT SLOPED ROOF**

DRAWING #

**MA/FA/BA 601**

SCALE  
N.T.S.

ISSUE/ REVISION DATE  
11-01-06