

EverGuard®  
Curb Type Tie In at Flat Roof  
MA/FA/BA 602

Diagram

Updated: 11/06



*Quality You Can Trust Since 1886...  
From North America's Largest Roofing Manufacturer™*

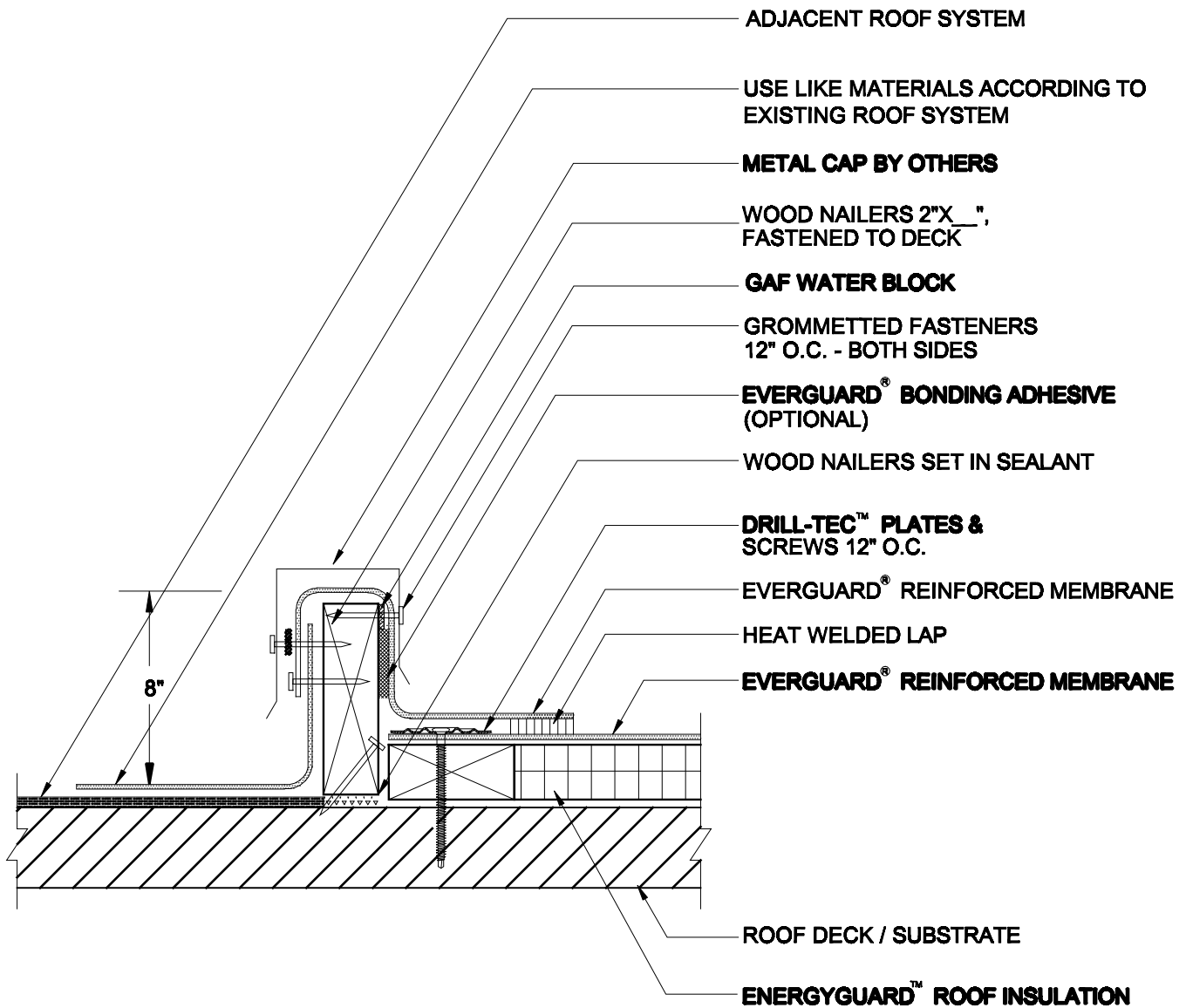

**NOTES:**

1. GAF DOES NOT WARRANT THE WATER TIGHT INTEGRITY OF TIE-INS TO OTHER MEMBRANE ROOF SYSTEMS.
2. FOR INSULATION THICKNESS GREATER THAN 6" CONTACT GAFMC CONTRACTOR SERVICES FOR ALTERNATE MEMBRANE ATTACHMENT REQUIREMENTS.
3. **PLATES AND SCREWS 6" O.C. REQ'D FOR BA SYSTEMS.**
4. APPLY EVERGUARD® TPO CUT EDGE SEALANT TO ALL CUT REINFORCED TPO EDGES ( REFER TO DETAIL MA/FA/BA 115 ).



**CURB TYPE TIE-IN AT FLAT ROOF**

DRAWING #

**MA/FA/BA 602**

SCALE	ISSUE/ REVISION DATE
N.T.S.	11-01-06