

EverGuard®
Coated Metal Sealant Box
Penetration Flashing
MA/FA/BA 509

Diagram

Updated: 4/09



*Quality You Can Trust Since 1886...
From North America's Largest Roofing Manufacturer™*

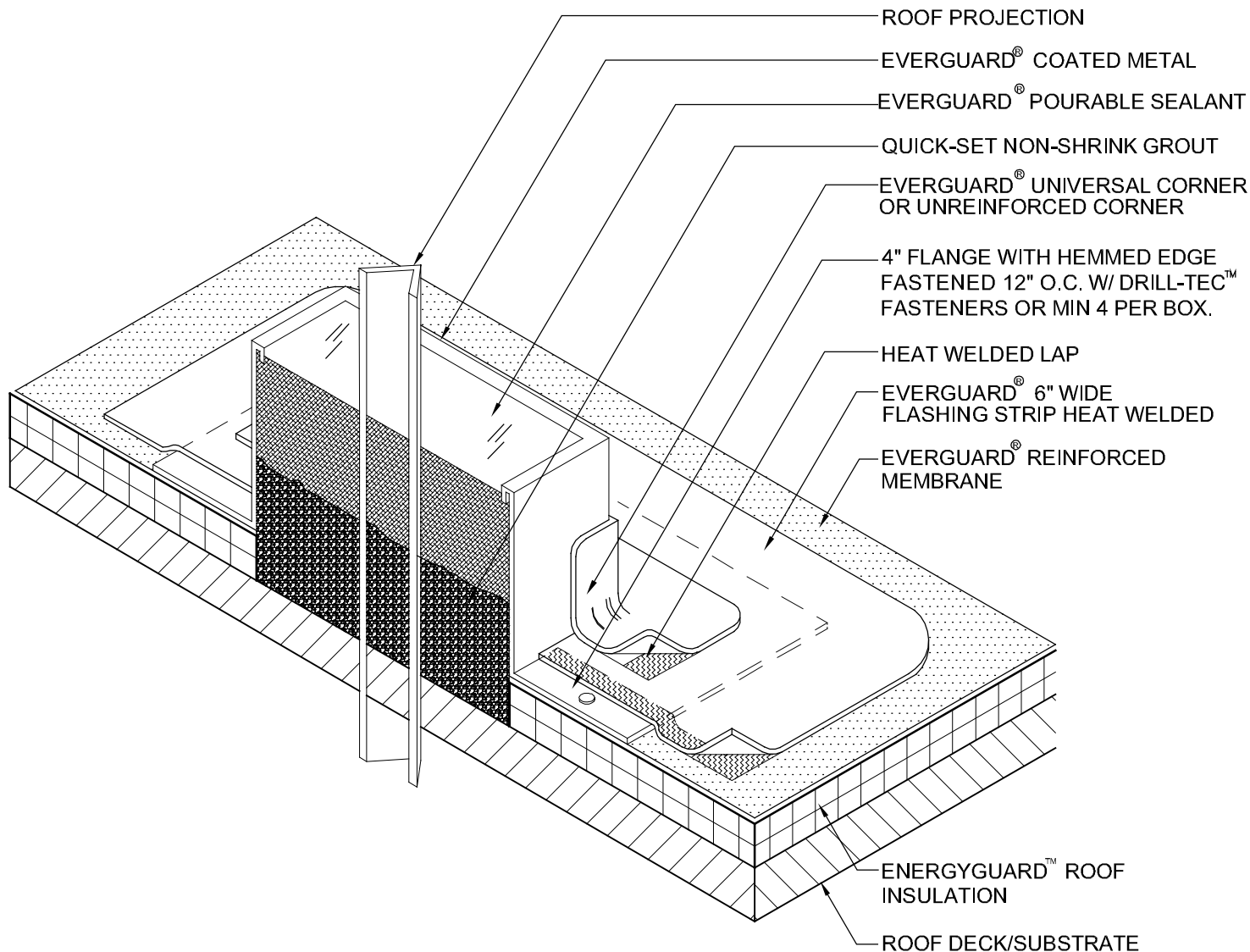

NOTE:

1. BEND EVERGUARD® COATED METAL TO FORM A SEALANT BOX AS SHOWN. STRIP IN VERTICAL SEAM WHERE BOX IS JOINED TOGETHER.
2. ALLOW 2" CLEARANCE AROUND THE PROJECTION. IF MULTIPLE PROJECTIONS, ALLOW 1" BETWEEN PROJECTION AND BOX.
3. INSIDE SURFACE OF EVERGUARD® COATED METAL SEALANT BOX (BARE METAL SIDE) MUST BE CLEAN AND DRY BEFORE SEALANT IS APPLIED.
4. EXISTING PROJECTION MUST BE CLEANED AND FREE OF ANY INSULATING MATERIALS .
5. PREFABRICATED HEAT WELDABLE TPO PIPE BOOTS MAY ALSO BE USED. CUT OFF STEPPED SECTIONS OF BOOT LEAVING LARGE BOTTOM OF BOOT INTACT. WELD FLANGE IN PLACE AND FILL WITH POURABLE SEALER TO TOP AND ADD STAINLESS STEEL BAND. (REFER TO DETAIL 522)
6. IF USING TPO BOOT, PRIME INSIDE OF BOOT. DO NOT CUT BOOT.
7. APPLY EVERGUARD® TPO AND PVC CUT EDGE SEALANT TO ALL CUT REINFORCED TPO AND PVC EDGES (REFER TO DETAIL MA/FA/BA 115).



ROOF PENETRATION SERIES

COATED METAL SEALANT BOX PENETRATION FLASHING

DRAWING #

509

SCALE

N.T.S.

SYSTEM

MA/FA/BA

ISSUE/ REVISION DATE

4-01-09