

EverGuard®
TPO to Existing EPDM
MA/FA/BA 609

Diagram

Updated: 11/06



*Quality You Can Trust Since 1886...
From North America's Largest Roofing Manufacturer™*

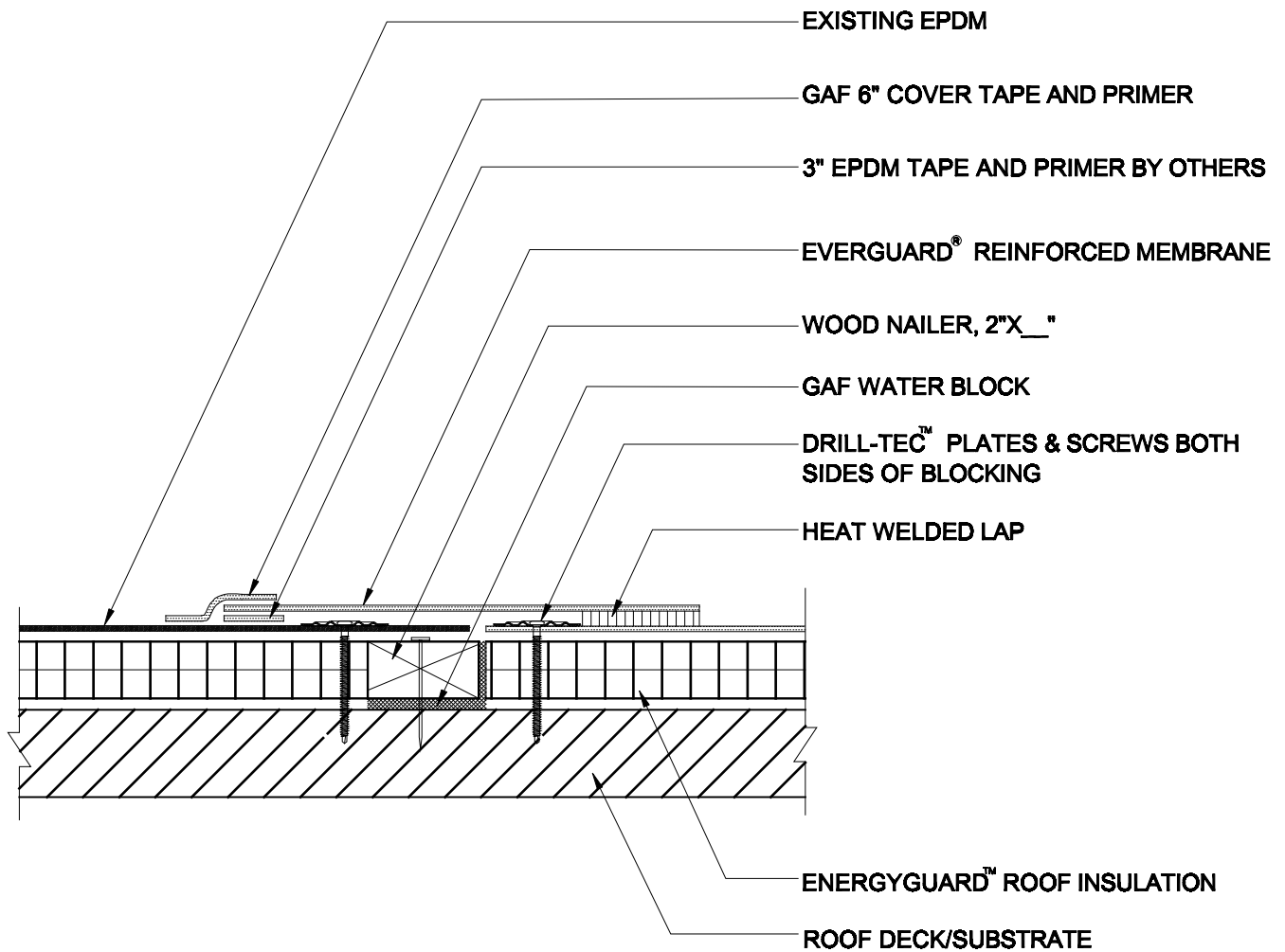

NOTE:

- 1. STONE/PAVER BALLAST (NOT SHOWN) REQD FOR BA SYSTEMS.
- 2. EVERGUARD® ADHESIVE/GAF ASPHALT REQUIRED FOR FA SYSTEMS.
- 3. PLATES & SCREWS 6" O.C. REQUIRED FOR BA SYSTEMS.
- 4. APPLY EVERGUARD® TPO CUT EDGE SEALANT TO ALL CUT REINFORCED TPO EDGES (REFER TO DETAIL MA/FA/BA 115).



TPO TO EXISTING EPDM

DRAWING #
MA/FA/BA 609

SCALE N.T.S.	ISSUE/ REVISION DATE 11-01-06
-----------------	----------------------------------