

# EverGuard® Threshold Flashing MA/FA/BA 312

Diagram

Updated: 11/06



*Quality You Can Trust Since 1886...  
From North America's Largest Roofing Manufacturer™*

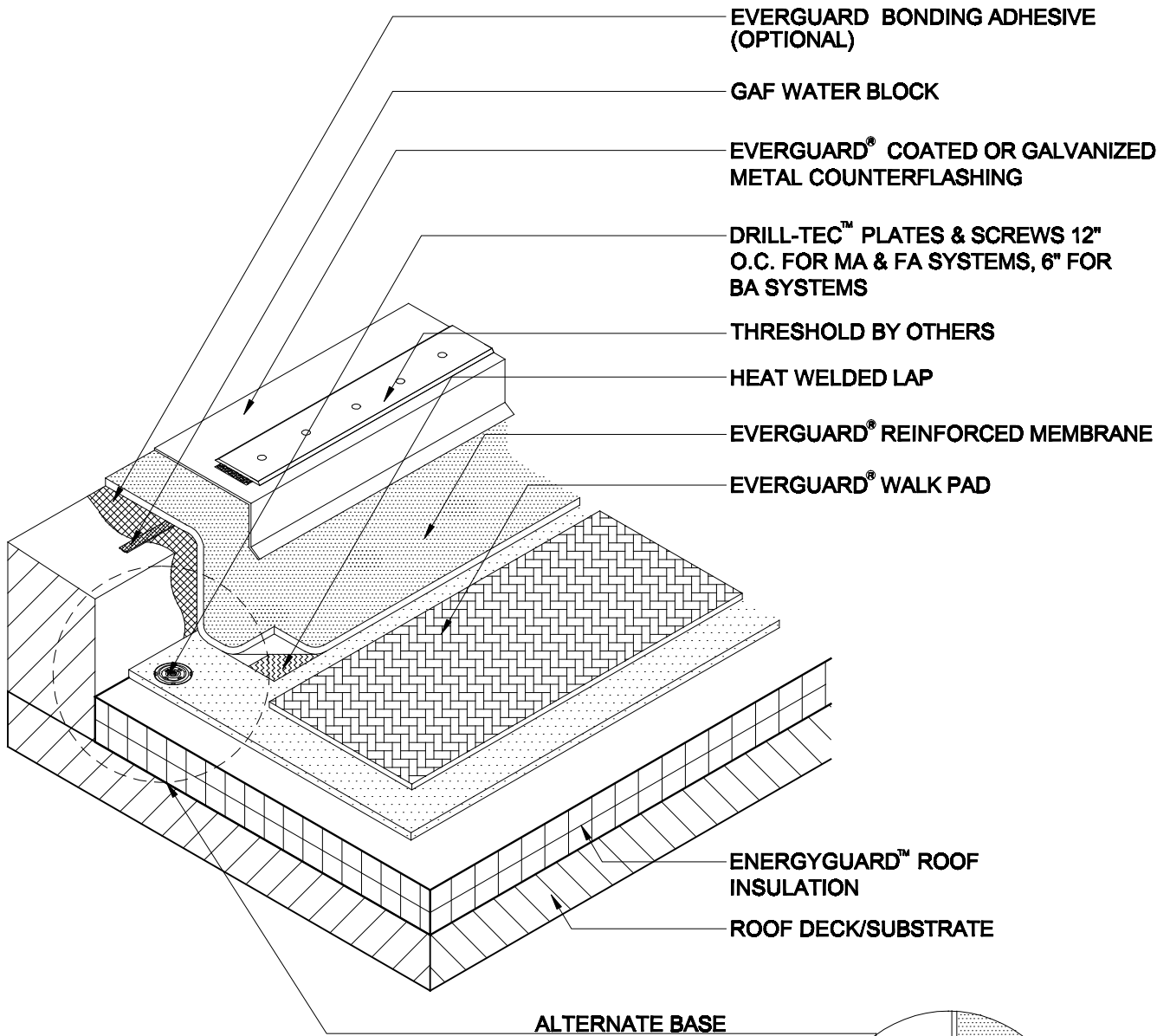

ALTERNATE BASE

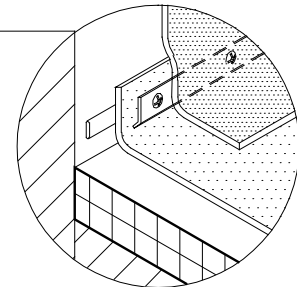

**NOTE:**

1. FOR INSULATION THICKNESS GREATER THAN 8" CONTACT GAFMC GUARANTEE SERVICES FOR ALTERNATE MEMBRANE ATTACHMENT REQUIREMENTS.
2. REFERENCE EVERGUARD® WALKWAY PAD SECUREMENT DETAIL.
3. WALKWAY PAD OR PAVER REQUIRED AT ALL ROOF ACCESS POINTS. FOR BA SYSTEMS PAVER IN LIEU OF PAD AND BALLAST PER SPEC
5. APPLY EVERGUARD® TPO CUT EDGE SEALANT TO ALL CUT REINFORCED TPO EDGES ( REFER TO DETAIL MA/FA/BA 115 ) AND ALL RS SEAMS.



**THRESHOLD FLASHING**

DRAWING #

**MA/FA/BA 312**

SCALE  
N.T.S.

ISSUE/ REVISION DATE  
11-01-06