

EverGuard®  
Cut Edge Sealant Detail  
MA/FA/BA 115

Diagram

Updated: 7/07



*Quality You Can Trust Since 1886...  
From North America's Largest Roofing Manufacturer™*

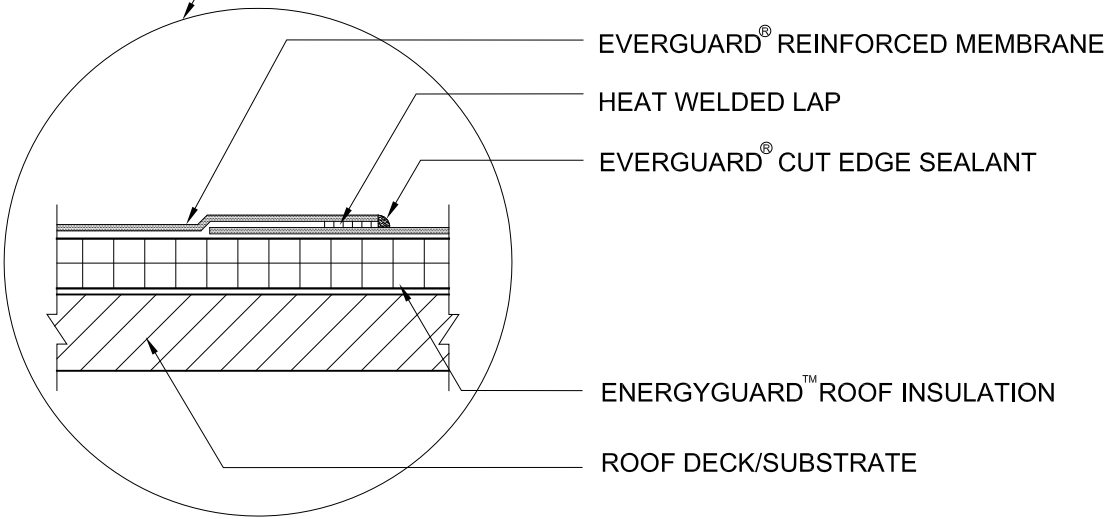
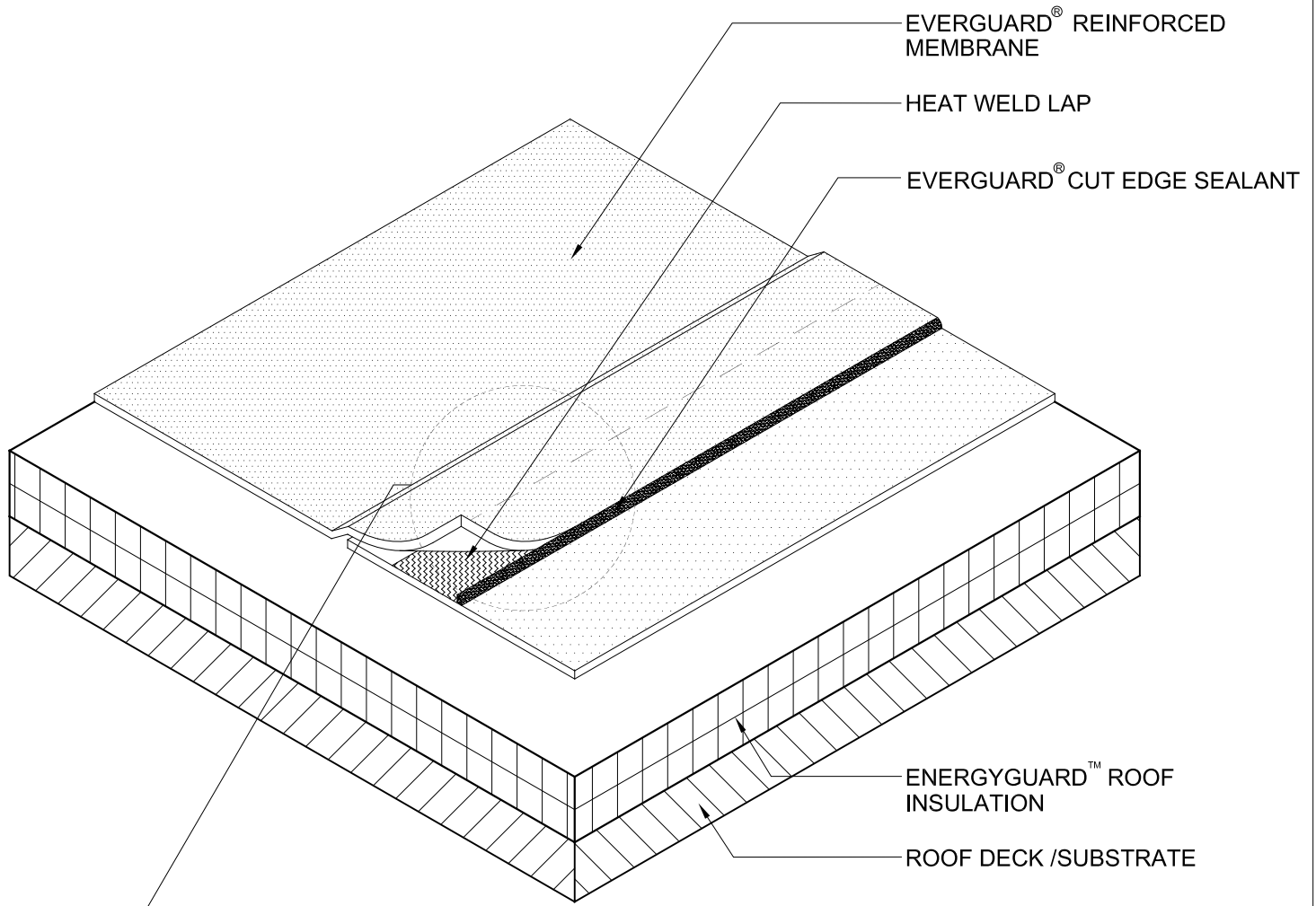

**NOTE:**

1. THIS DETAIL IS APPLIED TO TPO AND PVC ONLY.
2. EVERGUARD CUT EDGE SEALANT MUST BE USED ON ANY TPO AND PVC CUT EDGES WITH APPROPRIATE SEALANT.



**CUT EDGE SEALANT DETAIL**

TPO ONLY

DRAWING #

**MA/FA/BA 115**

SCALE	ISSUE/ REVISION DATE
N.T.S.	7-01-07