

EverGuard®
Drain PostTarget
MA/FA/BA 520

Diagram

Updated: 4/09



*Quality You Can Trust Since 1886...
From North America's Largest Roofing Manufacturer™*

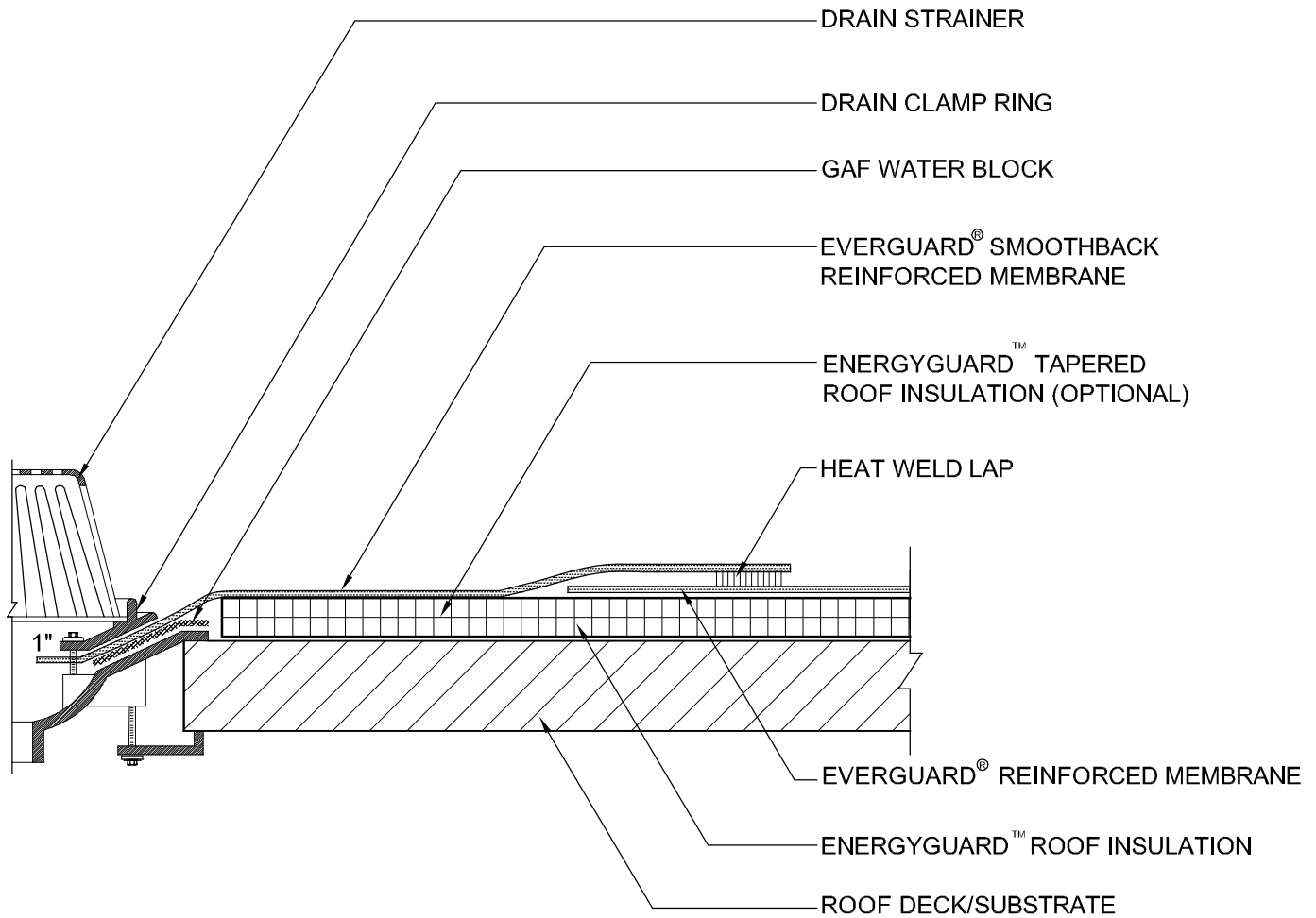

NOTE:

1. A FIELD WELD CANNOT PASS WITHIN 9" OF THE CLAMPING , OR WITHIN THE DRAIN SUMP ITSELF.
2. MEMBRANE MUST EXTEND MINIMUM 1" BEYOND THE BOLT HOLES, THE CLAMPING RING BOLTS MUST PENETRATE THE MEMBRANE.
3. TAPERED INSULATION TO CREATE A ROOF SUMP MINIMUM 36" X 36" IN SIZE (OPTIONAL).
4. DO NOT RUN SEPERATION SHEET INTO BOWL AREA IF USED IN SYSTEM.
5. CUT AND REMOVE FIRST SHEET FROM BOWL AREA. REMOVE FIRST LAYER AT MEMBRANE FROM BOWL AREA.
6. APPLY EVERGUARD® TPO AND PVC CUT EDGE SEALANT TO ALL CUT REINFORCED TPO AND PVC EDGES (REFER TO DETAIL MA/FA/BA 115).

 GAF MATERIALS CORPORATION www.gaf.com	 SINGLE-PLY ROOFING SYSTEMS	<h2>DRAIN - POST TARGET</h2>	DRAWING #	SYSTEM
	ROOF PENETRATION SERIES		520	MA/FA/BA
			SCALE	ISSUE/ REVISION DATE
			N.T.S.	4-01-09