

EverGuard®
Change of Plane Detail
MA/BA/FA 112

Diagram

Updated: 11/06



*Quality You Can Trust Since 1886...
From North America's Largest Roofing Manufacturer™*

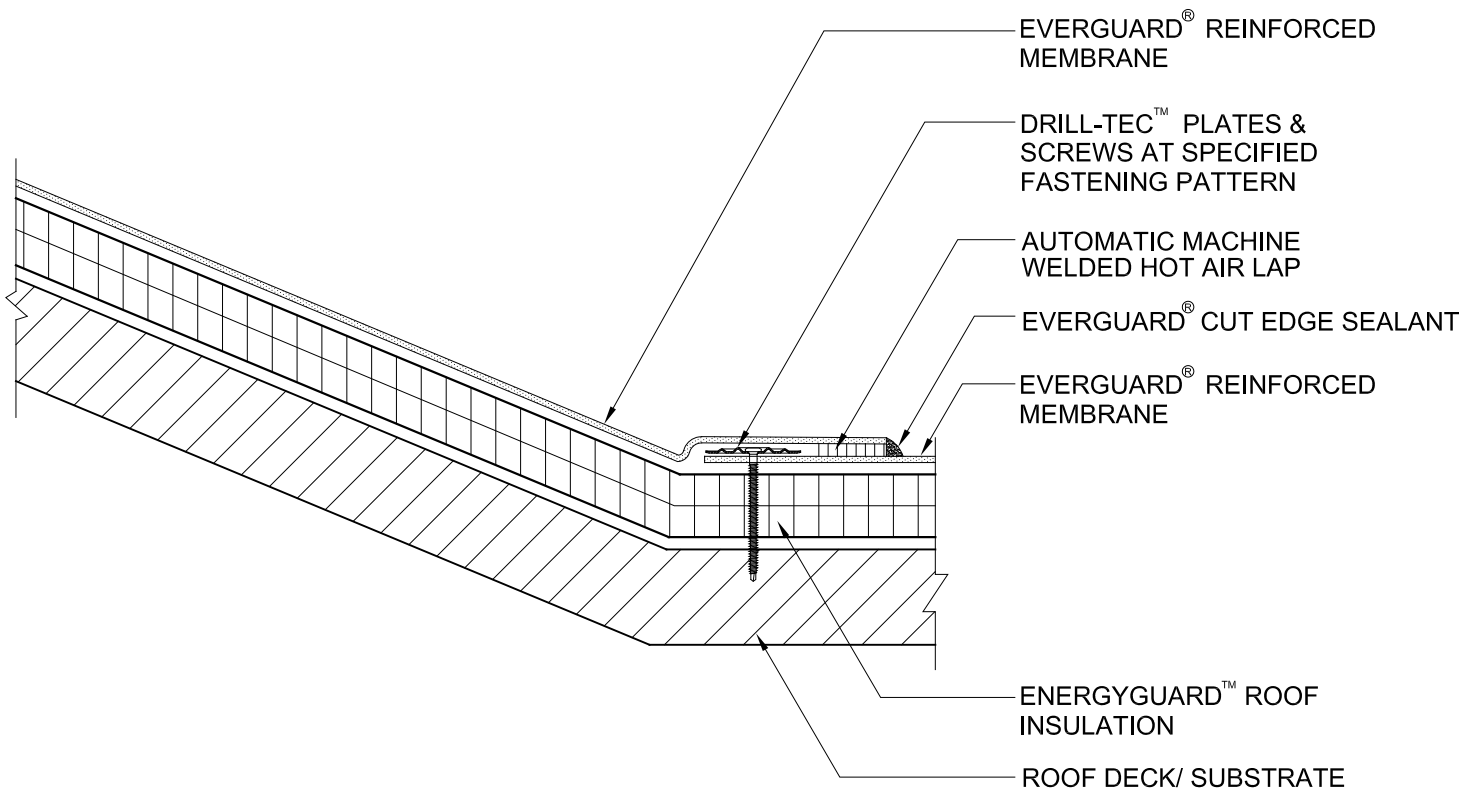

NOTE:

1. THE FOLLOWING APPLIES FOR MA SYSTEMS ONLY: FOR INSULATION THICKNESSES GREATER THAN 8", CONTACT GAF CONTRACTOR SERVICES FOR ALTERNATE ATTACHMENT REQUIREMENTS. THESE METHODS MAY INCLUDE THE USE OF A HARD BOARD COVERING THE ASSEMBLY.
2. EVERGUARD® ADHESIVE/ HOT ASHALT REQUIRED FOR FA SYSTEMS.
3. DRILL-TEC™ PLATES & SCREWS 6" O.C. REQ'D FOR BA SYSTEMS.
4. ANYTHING 2:12 OR GREATER NEEDS TO BE FASTENED AT ANGLE CHANGE.
5. APPLY EVERGUARD® TPO AND PVC CUT EDGE SEALANT TO ALL CUT REINFORCED TPO AND PVC EDGES (REFER TO DETAIL MA/FA/BA 115).



CHANGE OF PLANE DETAIL

DRAWING #

MA/BA/FA 112

SCALE	ISSUE/ REVISION DATE
N.T.S.	11-01-06