

EverGuard® Ridge Detail MA 110

Diagram

Updated: 7/07



*Quality You Can Trust Since 1886...
From North America's Largest Roofing Manufacturer™*

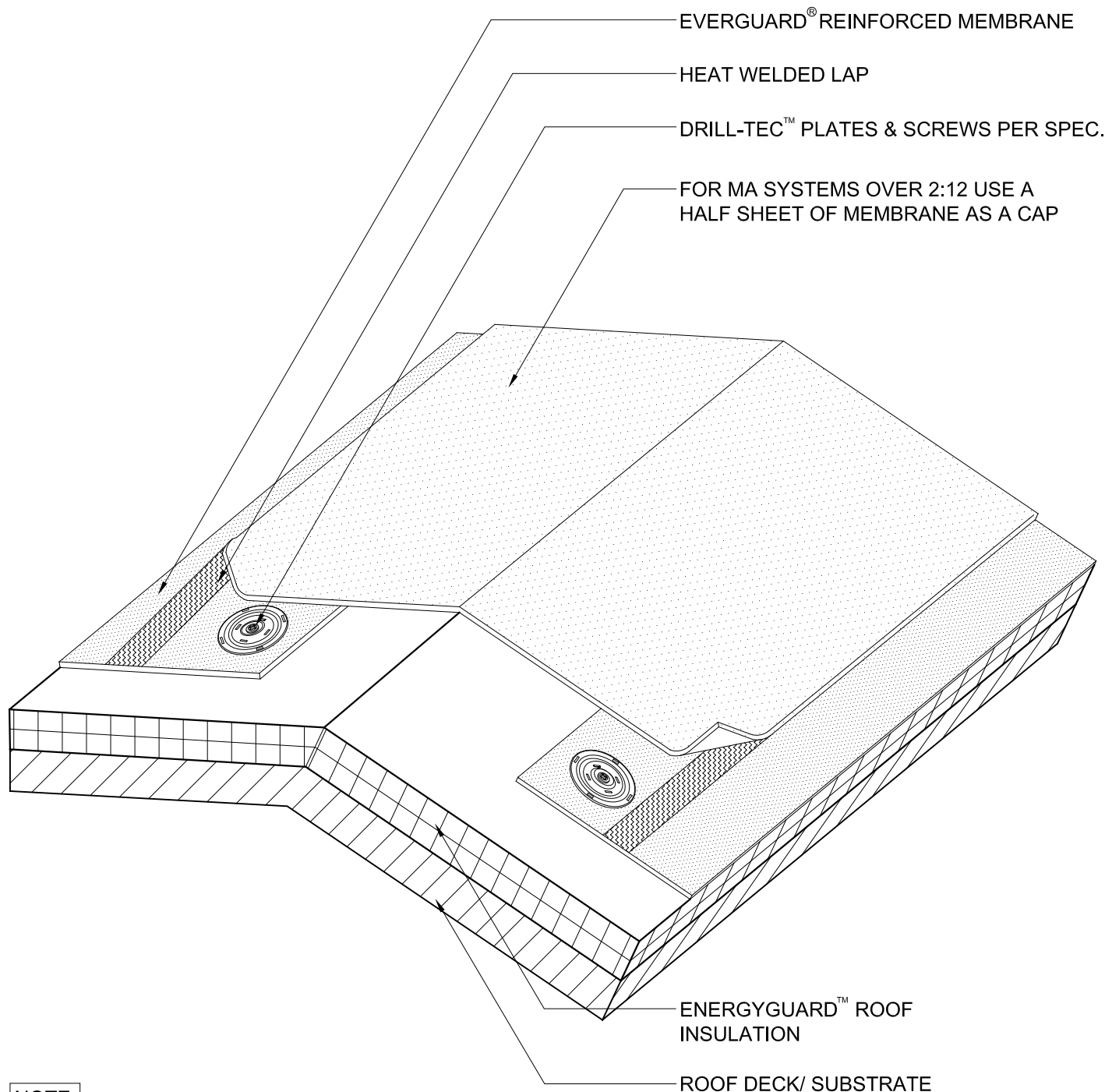

NOTE:

1. FA AND BA SYSTEMS DO NOT REQUIRE FASTENERS AT RIDGE AREA.
2. THE FOLLOWING APPLIES FOR MA SYSTEMS ONLY: FOR INSULATION THICKNESSES GREATER THAN 8", CONTACT GAF CONTRACTOR SERVICES FOR ALTERNATE ATTACHMENT REQUIREMENTS. THESE METHODS MAY INCLUDE THE USE OF A HARD BOARD COVERING THE ASSEMBLY.
3. DO NOT RUN CAP SHEET INTO THE PERIMETER HALF SHEET REGION IN MA SYSTEMS.
4. APPLY EVERGUARD[®] TPO AND PVC CUT EDGE SEALANT TO ALL CUT REINFORCED TPO AND PVC EDGES (REFER TO DETAIL MA/FA/BA 115).