

EverGuard®  
Field Fabricated Expansion  
Joint - Curb Type  
MA/FA/BA 402B

Diagram

Updated: 7/07



*Quality You Can Trust Since 1886...  
From North America's Largest Roofing Manufacturer™*

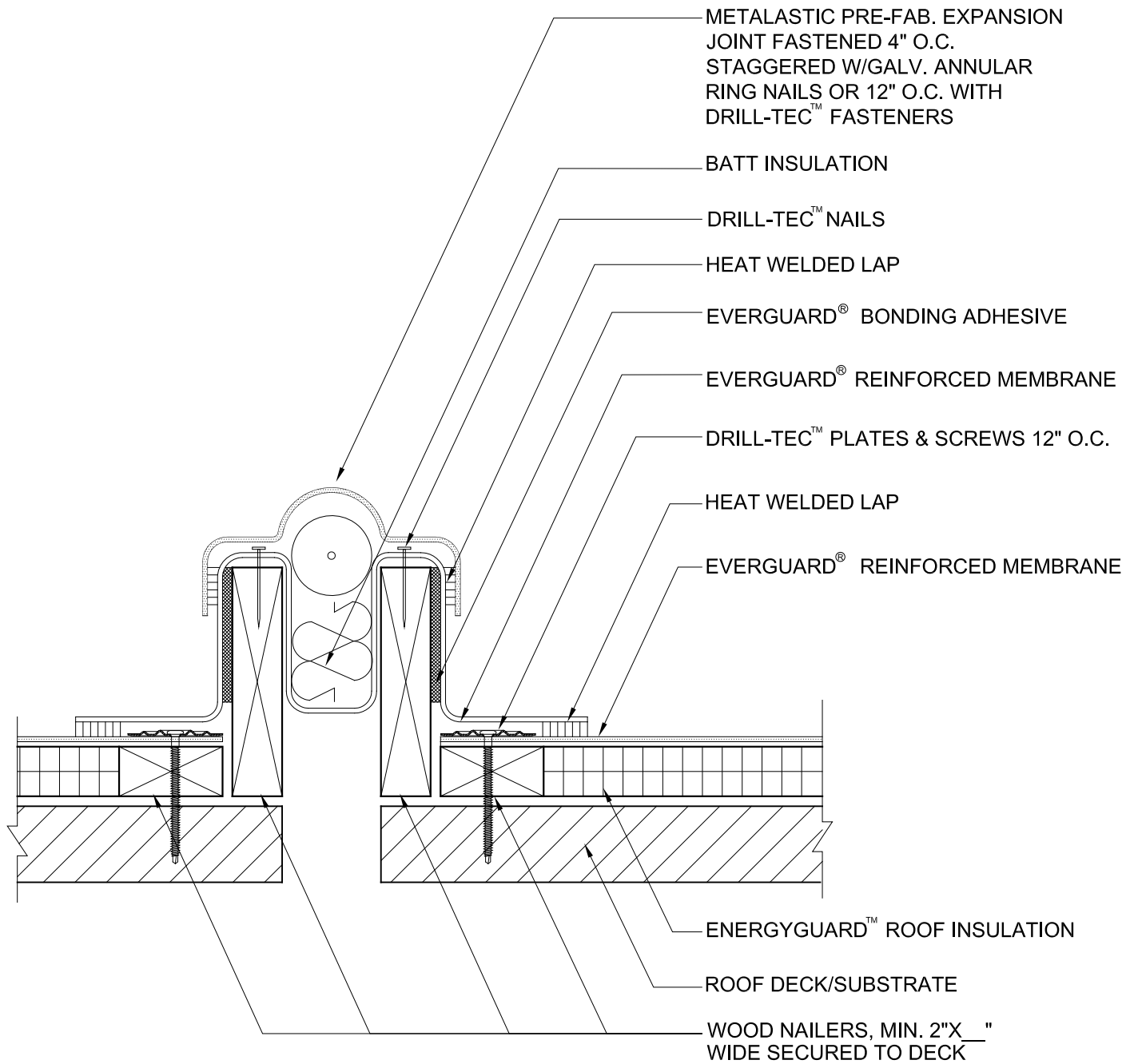

**NOTE:**

1. STONE/PAVER BALLAST (NOT SHOWN) REQ'D FOR BA SYSTEMS.
2. PLATES & SCREWS 8" O.C. REQ'D FOR BA SYSTEMS.
3. ALL FLASHINGS ON EXPANSION JOINTS MUST BE ADHERED.
4. EVERGUARD® ADHESIVE/GAF ASPHALT REQUIRED FOR FA SYSTEMS.
5. APPLY EVERGUARD® PVC CUT EDGE SEALANT TO ALL CUT REINFORCED PVC EDGES ( REFER TO DETAIL MA/FA/BA 115 ).



**FIELD FABRICATED EXPANSION JOINT - CURB TYPE**

PVC ONLY

DRAWING #

MA/FA/BA 402B

SCALE	ISSUE/ REVISION DATE
N.T.S.	7-01-07