

Insulated PVC Mechanically Attached Systems Specification Plate

Specification



*Quality You Can Trust Since 1886...
From North America's Largest Roofing Manufacturer™*

INSULATED PVC MECHANICALLY ATTACHED SYSTEMS SPECIFICATION PLATE

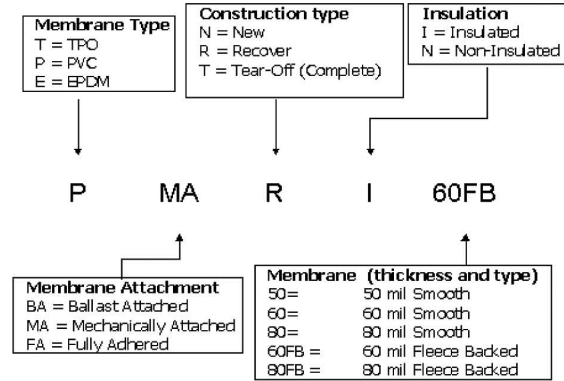
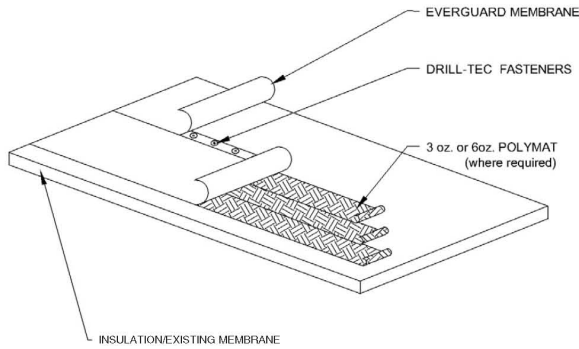

Specification Number	Attachment Type	Construction Type	Insulation	PVC Thickness	Guarantee Length Up To (Years)
P-MA-N-I-50	Mechanically Attached	New	Yes	.050	12
P-MA-N-I-60				.060	15
P-MA-N-I-80				.080	20
P-MA-T-I-50	Mechanically Attached	Tear Off	Yes	.050	12
P-MA-T-I-60				.060	15
P-MA-T-I-80				.080	20
P-MA-R-I-50	Mechanically Attached	Recover	Yes	.050	12
P-MA-R-I-60				.060	15
P-MA-R-I-80				.080	20
P-MA-N-I-60FB	Mechanically Attached	New	Yes	.060 FB	15
P-MA-N-I-80FB				.080FB	20
P-MA-T-I-60FB	Mechanically Attached	Tear Off	Yes	.060 FB	15
P-MA-T-I-80FB				.080FB	20
P-MA-R-I-60FB	Mechanically Attached	Recover	Yes	.060 FB	15
P-MA-R-I-80FB				.080FB	20

Refer to Insulation Attachment and Membrane Attachment Tables for attachment requirements. Mechanically attached system require the use of half sheets.