

Freedom™
Premolded Penetration Flashing
FD 506

Diagram

Updated: 11/06



*Quality You Can Trust Since 1886...
From North America's Largest Roofing Manufacturer™*

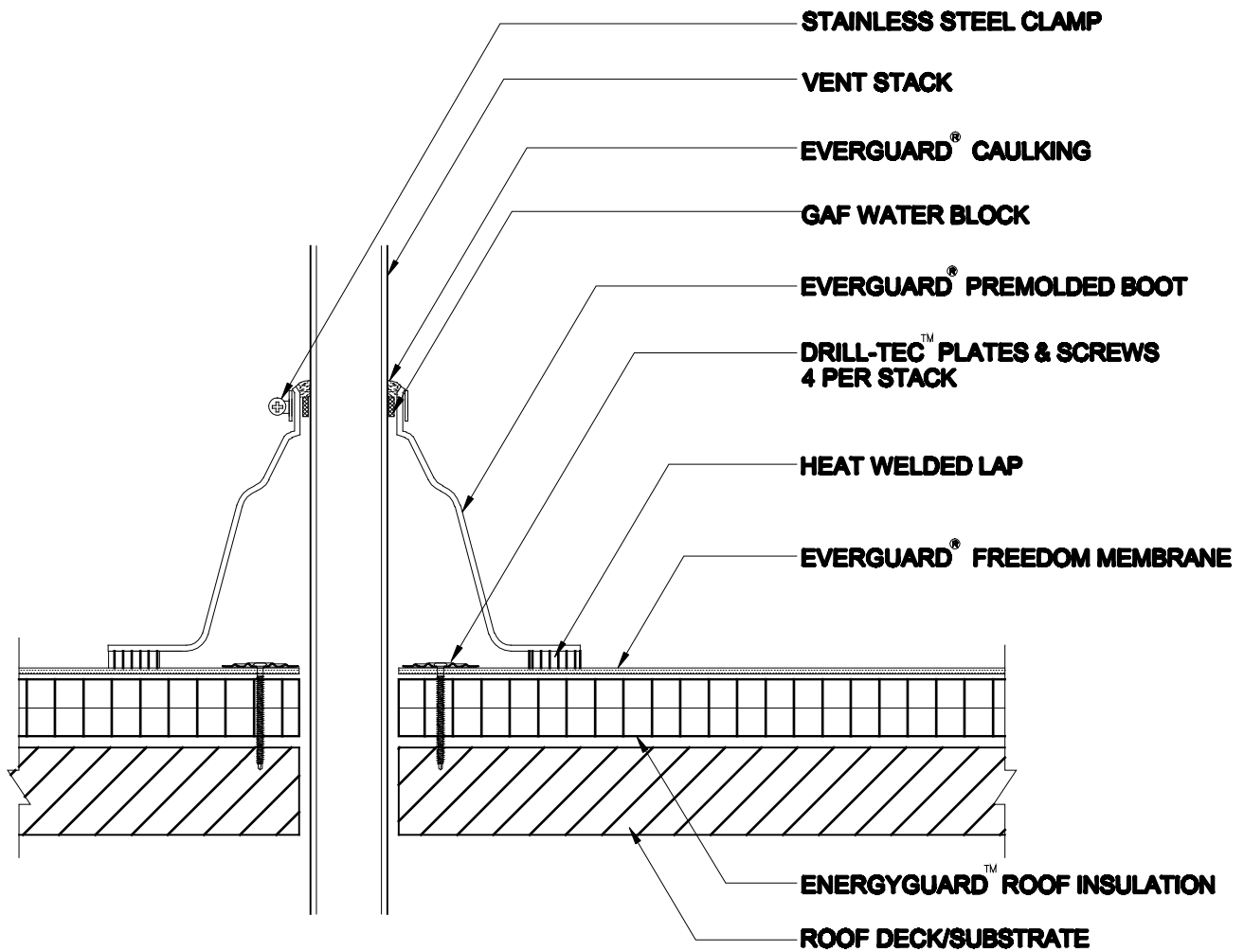

NOTE:

1. DO NOT CUT PREMOLDED BOOT. IT MUST BE PULLED OVER VENT PIPE.
2. IF THE PLATES AND FASTENERS INTRUDE INTO BOOT FLANGE AREA, THEN A TARGET MUST FIRST BE INSTALLED OVER PLATES AND FASTENERS BEFORE BOOT INSTALLATION.
3. APPLY EVERGUARD® TPO CUT EDGE SEALANT TO ALL CUT REINFORCED TPO EDGES (REFER TO DETAIL FD 115).



PREMOLDED PENETRATION FLASHING

FREEDOM HW ONLY

DRAWING #

FD 506

SCALE
N.T.S.

ISSUE/ REVISION DATE
11-01-06