

Freedom™
Concealed Wood Equipment Support
FD 512

Diagram

Updated: 11/06



*Quality You Can Trust Since 1886...
From North America's Largest Roofing Manufacturer™*

RS MAX 10 YR WARRANTY

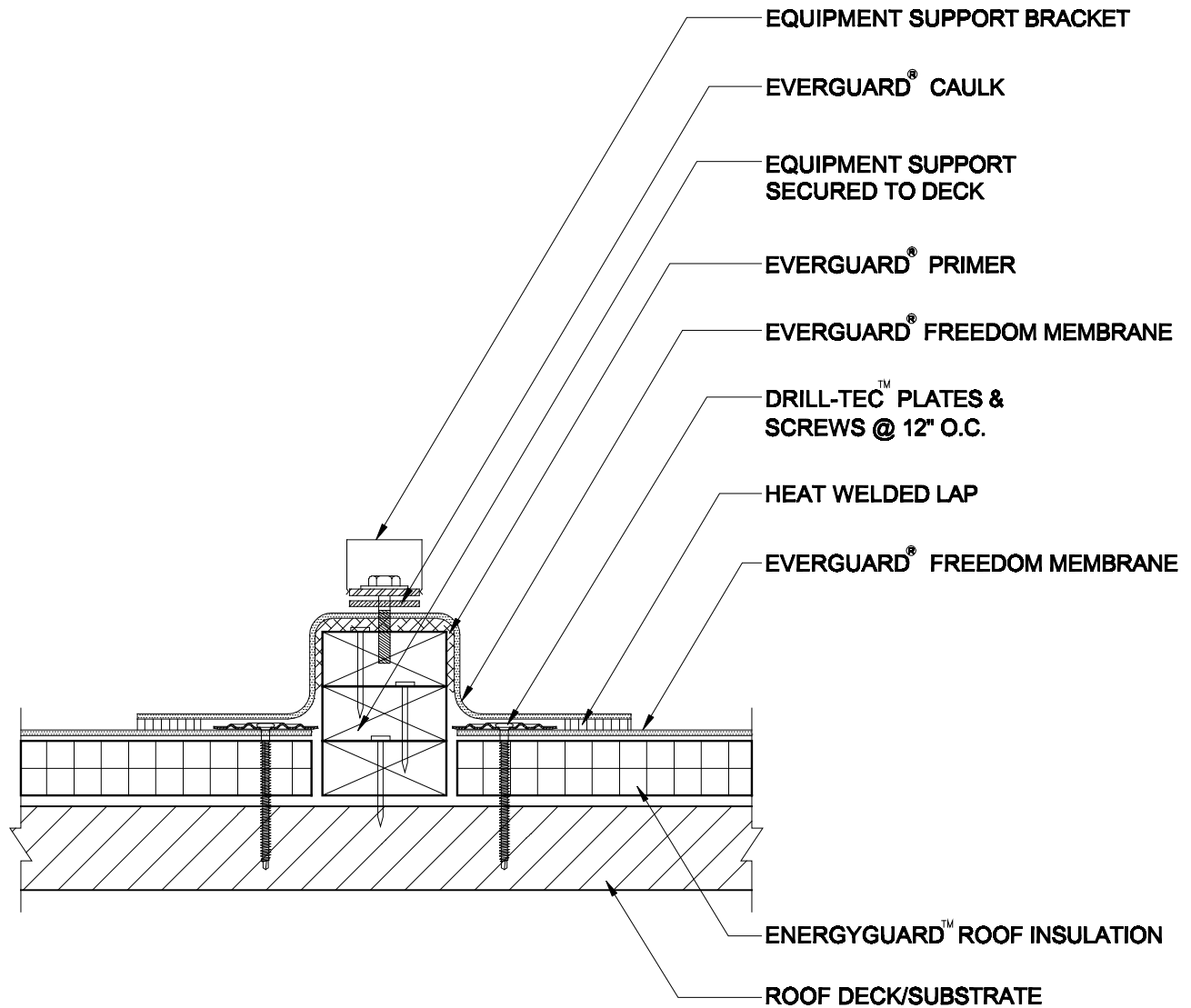

NOTE:

1. FOR INSULATION THICKNESS GREATER THAN 8", CONTACT GAFMC CONTRACTOR SERVICES FOR ALTERNATE MEMBRANE ATTACHMENT REQUIREMENTS.
2. TO MAKE A SEAM ON RS WITHOUT RS PRESENT, YOU MUST USE GAF CLEANER AS WELL AS GAF PRIMER TO PREP THE AREA.
3. APPLY EVERGUARD® TPO CUT EDGE SEALANT TO ALL CUT REINFORCED TPO EDGES (REFER TO DETAIL FD 115) AND ALL RS SEAMS.



**CONCEALED WOOD EQUIPMENT
SUPPORT**

FREEDOM RS & HW

DRAWING #
FD 512

SCALE	ISSUE/ REVISION DATE
N.T.S.	11-01-06