

# Freedom™ Post Target FD 513

## Diagram

Updated: 11/06



*Quality You Can Trust Since 1886...  
From North America's Largest Roofing Manufacturer™*

**RS MAX 10 YR WARRANTY**

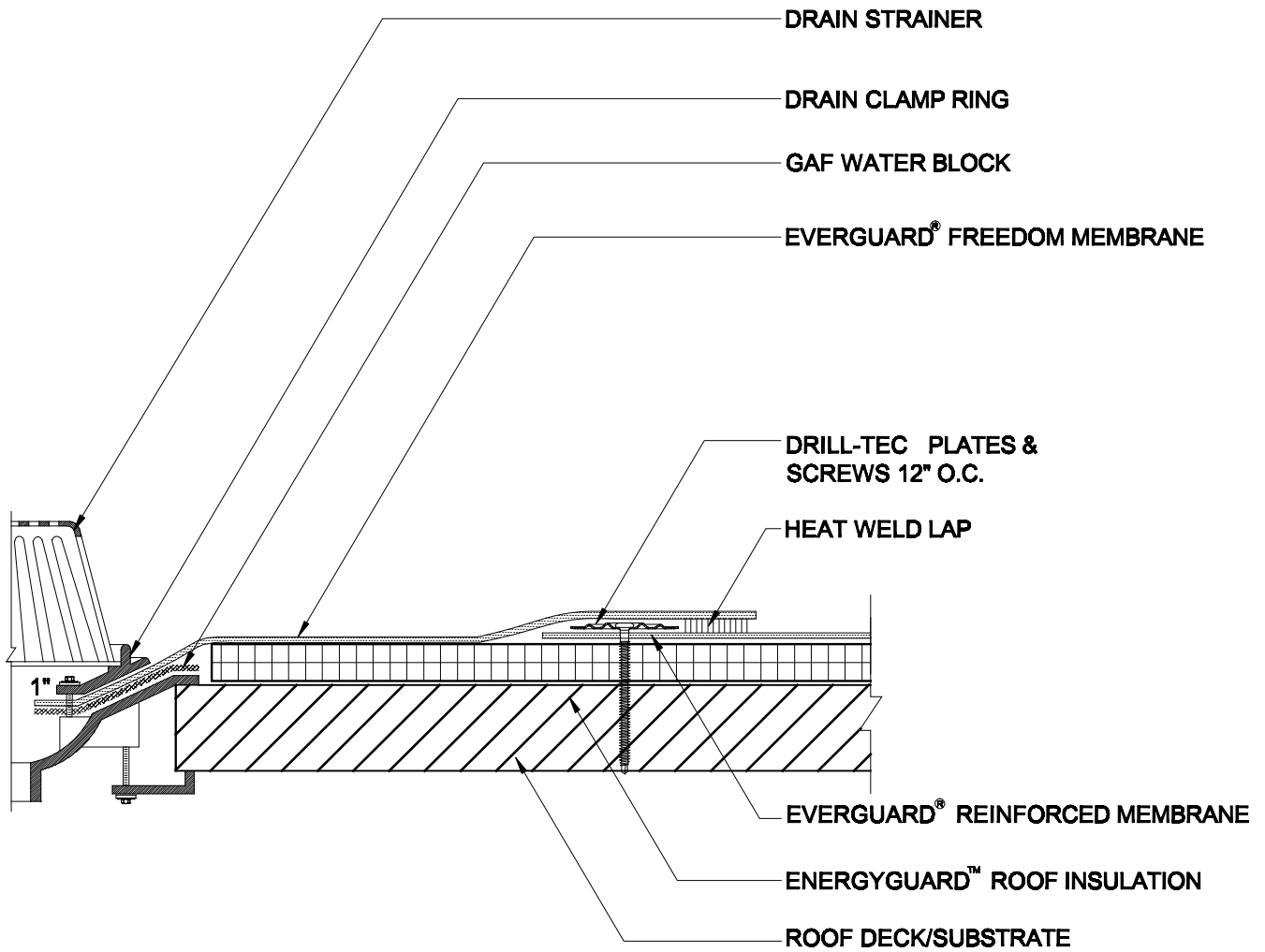

**NOTE:**

1. A FIELD WELD CANNOT PASS WITHIN 9" OF THE CLAMPING , OR WITHIN THE DRAIN SUMP ITSELF.
2. MEMBRANE MUST EXTEND MINIMUM 1" BEYOND THE BOLT HOLES, THE CLAMPING RING BOLTS MUST PENETRATE THE MEMBRANE.
3. TAPERED INSULATION TO CREATE A ROOF SUMP MINIMUM 36" X 36" IN SIZE (OPTIONAL).
4. DO NOT RUN SEPERATION SHEET INTO BOWL AREA IF USED IN SYSTEM.
5. APPLY EVERGUARD® CUT EDGE SEALANT TO ALL RAPIDSEAM EDGES ( REFER TO DETAIL FD 115 ).



**POST TARGET**

**FREEDOM RS ONLY**

DRAWING #

**FD 513**

SCALE

N.T.S.

ISSUE/ REVISION DATE

11-01-06