

Freedom™
Curb Type Tie In at Flat Roof
FD 602

Diagram

Updated: 11/06



*Quality You Can Trust Since 1886...
From North America's Largest Roofing Manufacturer™*

RS MAX 10 YR WARRANTY

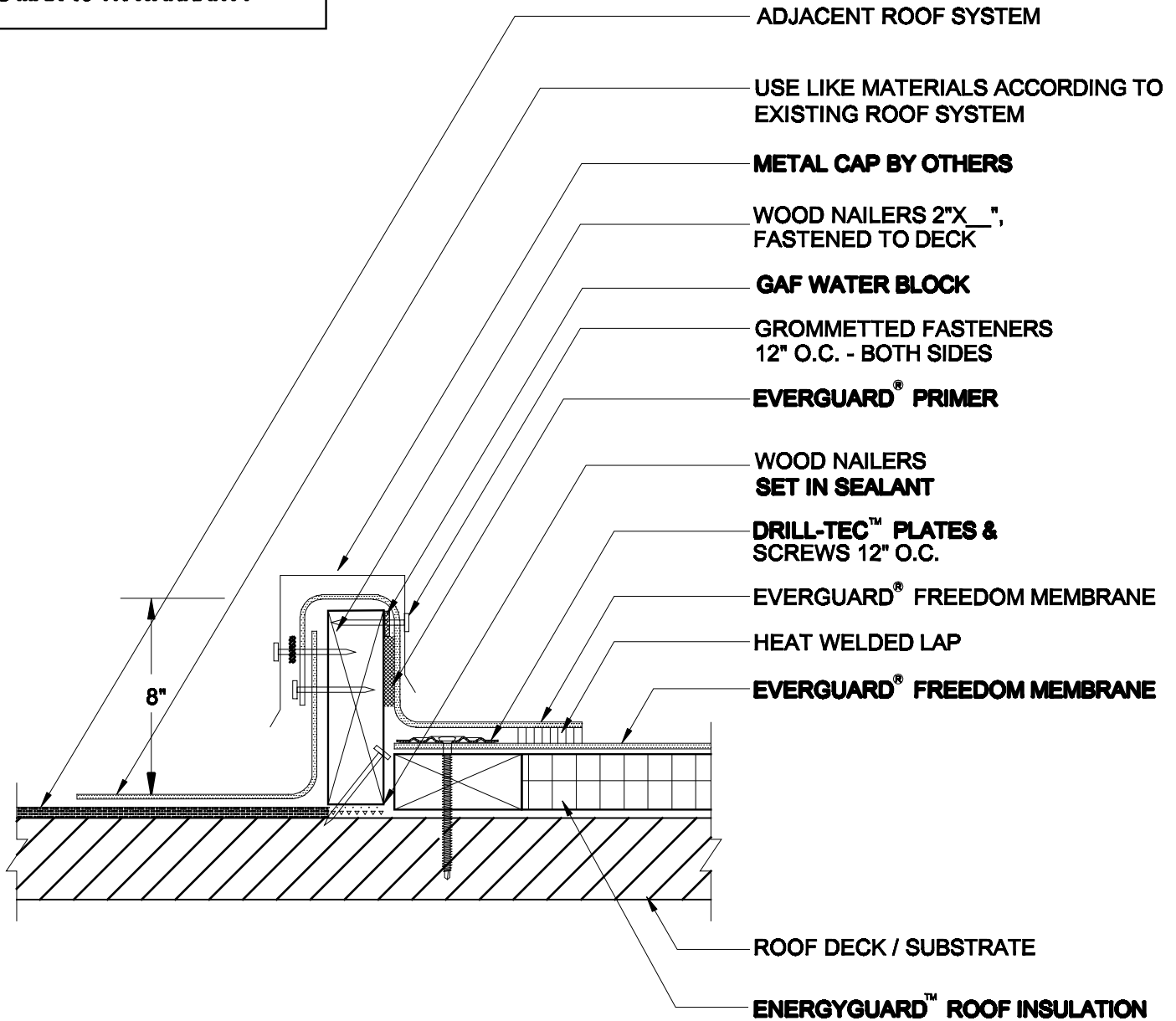

NOTES:

1. GAF DOES NOT WARRANT THE WATER TIGHT INTEGRITY OF TIE-INS TO OTHER MEMBRANE ROOF SYSTEMS.
2. FOR INSULATION THICKNESS GREATER THAN 6" CONTACT GAFMC CONTRACTOR SERVICES FOR ALTERNATE MEMBRANE ATTACHMENT REQUIREMENTS.
3. TO MAKE A SEAM ON RS WITHOUT RS PRESENT, YOU MUST USE GAF CLEANER AS WELL AS GAF PRIMER TO PREP THE AREA.
4. APPLY EVERGUARD® TPO CUT EDGE SEALANT TO ALL CUT REINFORCED TPO EDGES (REFER TO DETAIL FD 115) AND ALL RS SEAMS.



CURB TYPE TIE-IN AT FLAT ROOF

FREEDOM RS & HW

DRAWING #
FD 602

SCALE	ISSUE/ REVISION DATE
N.T.S.	11-01-06