

# Flat Edge Flashing Detail MB/BUR 1

Diagram



*Quality You Can Trust Since 1886...  
From North America's Largest Roofing Manufacturer™*

# MB 1/BUR 1 – FLAT EDGE FLASHING DETAIL



Flashing Details

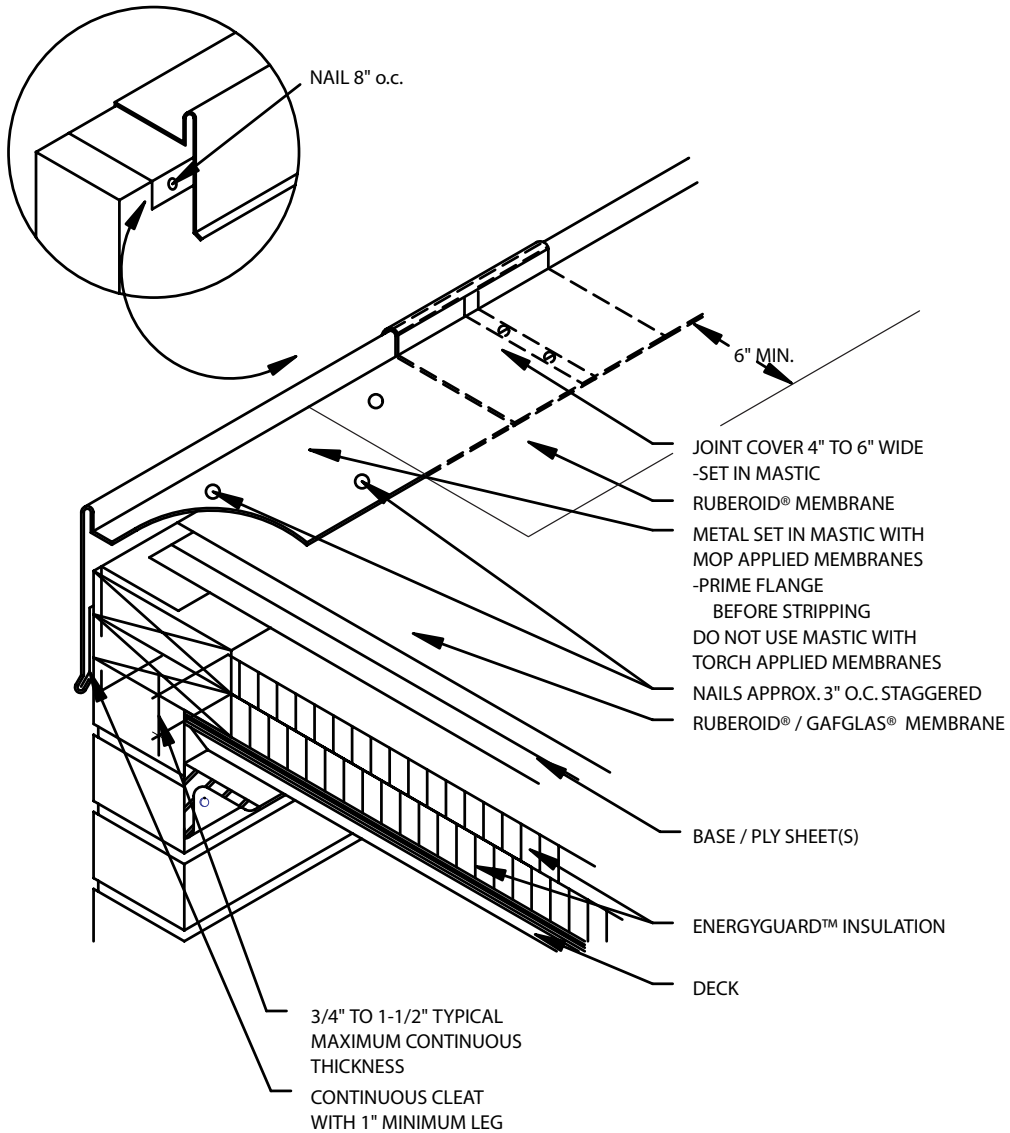

## NOTES:

1. BASE/PLY SHEET(S) TURNED OVER EDGE A MINIMUM OF 1 1/2" (38mm) OR THICKNESS OF NAILER WHICHEVER IS GREATER
2. THIS DETAIL SHOULD BE USED ONLY WHERE WATER DRAINS AWAY FROM EDGE
3. SET PRIMED FLANGE IN ROOF CEMENT ON MOP MB, COLD MB AND BUR. SET FLANGE IN HEAT SOFTENED MEMBRANE ON TORCH APP AND HEAT-WELD SBS SYSTEMS.