

# Flat Edge Flashing Detail For Granule Surfaced Membranes MB/BUR 2

Diagram



*Quality You Can Trust Since 1886...  
From North America's Largest Roofing Manufacturer™*

# MB 2/BUR 2 – FLAT EDGE FLASHING DETAIL FOR GRANULE SURFACED MEMBRANE



Flashing Details

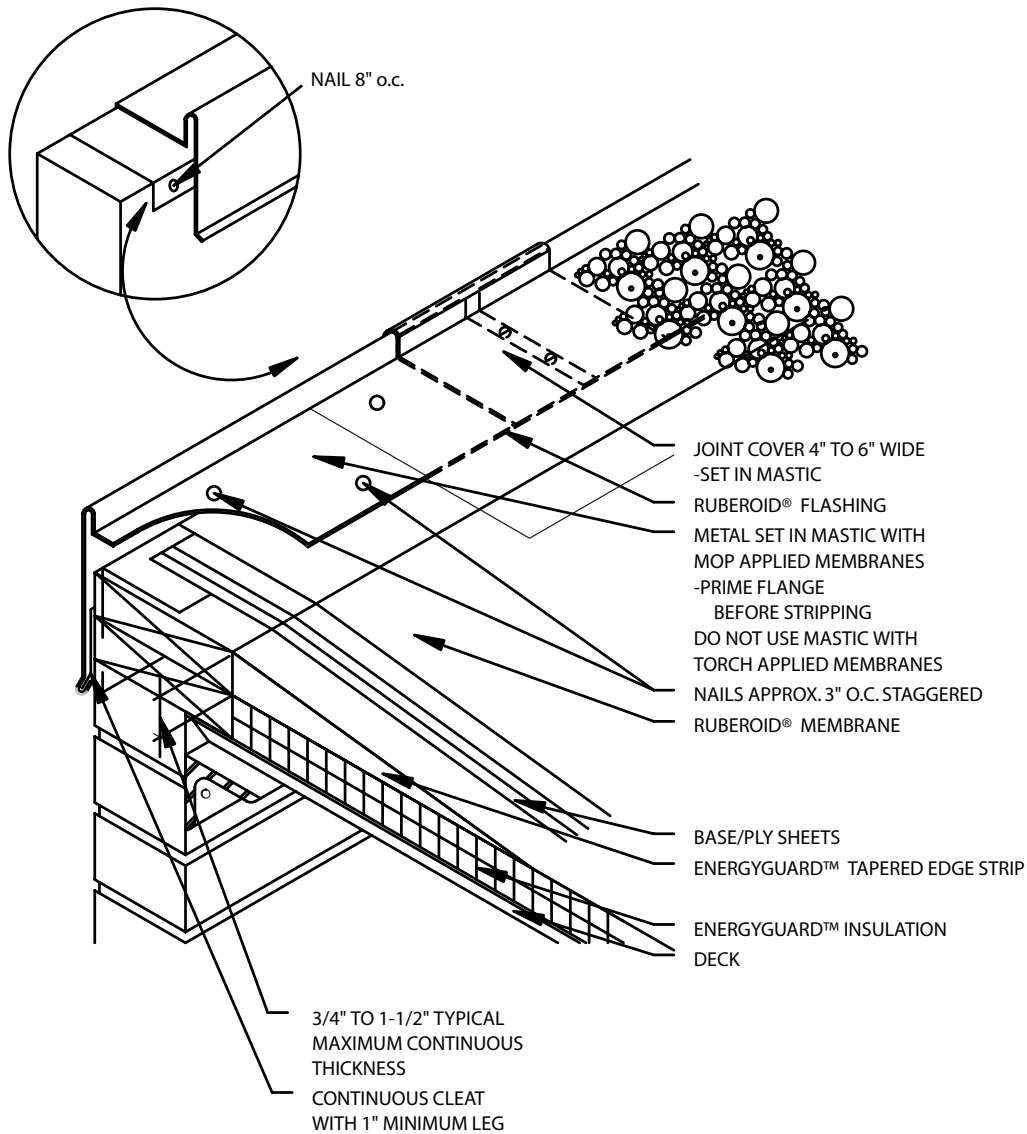

## NOTES:

1. BASE/PLY SHEET(S) TURNED OVER EDGE A MINIMUM OF 1 1/2" (38mm) OR THICKNESS OF NAILER WHICHEVER IS GREATER
2. SET PRIMED FLANGE IN ROOF CEMENT ON MOP MB, COLD MB AND BUR. SET FLANGE IN HEAT SOFTENED MEMBRANE ON TORCH APP AND HEAT-WELD SBS SYSTEMS.